



FLUORESCENT TOOLS



SETS FLUO

Sets FLUO **807**



FIXED AND VARIABLE OPENING WRENCHES

809

Combination wrenches FLUO **809**
 Ratchet wrenches FLUO **810**
 Open end wrenches FLUO **810**
 Variable opening wrenches FLUO **811**



RATCHETS - SOCKETS - ACCESSORIES

812

Socket wrenches FLUO **812**
 Ratchets 1/4" FLUO **812**
 Sockets 1/4" FLUO **815**
 Ratchets 3/8" FLUO **817**
 Sockets 3/8" FLUO **818**
 Standard 1/2" Range FLUO **819**



SCREWDRIVERS - KEYS - BITS FLUO

820

PROTWIST® Screwdriver FLUO **820**
 PROTWIST® keys FLUO **824**
 Key sleeve set FLUO **824**
 Bits FLUO **825**
 Bit holders and accessories FLUO **828**



PLIERS - CIRCLIP® PLIERS - LOCK-GRIP PLIERS

830

Engineers multigrip pliers FLUO **830**
 Pliers FLUO **831**
 Pliers with outcut retainer FLUO **834**
 Electrical engineers pliers FLUO **837**
 Pliers FLUO **840**
 Circlip® pliers FLUO **840**
 Locking-wire pliers FLUO **841**
 "Connector" pliers FLUO **841**



MEASURING - MARKING-OUT

842

Rules - Gauges FLUO **842**
 Making-Out FLUO **842**



HAMMERS - IMPACT TOOLS

843

Hammers - Mallets FLUO **843**
 Drifts FLUO **844**
 Drift punches FLUO **844**



FLUORESCENT TOOLING

844

Scissors - Inspection mirrors **844**
 Inspection mirrors **845**
 UV torch **845**



FLUO

RFid

NEW RANGE OF FLUORESCENT TOOLS



Your solution for "black or dark zones"

Detect the tool thanks to its fluorescence, activated by a lamp or UV neon light.
Detectable in black or dark environment up to 5 metres.

SAFETY

- Effective colour code for detection even in broad daylight
- Higher visibility on the tool, particularly in dark areas: no risks of accidents, injury, incidents, etc.
- No chipping or scaling due to a fall or shock, no loss of elements or accessory from the product.

FLUO

ERGONOMICS

- No larger than standard tools.
- Good product grip.



IMPROVED PRODUCTIVITY

- Tools compatible with rolling cabinet storage modules.
- No time wasted searching for lost tools.
- Easy cleaning.

COST REDUCTIONS

- No lost tools to be replaced.
- Lifetime identical to a standard tool.



A comprehensive range of products meeting the most common applications: wrenches, ratchets, sockets, gauges, pliers, hammers, rules, etc.



SETS FLUO

BVFC1.FLUO-1 143-piece set of metric fluorescent tools - foam trays and sealed box

- For all types of maintenance operations in locations requiring good visibility on the tooling.
- 2 Options available:
 - CM.AEFLUO-1: Set supplied without container.
 - BVFC1.FLUO-1: Set supplied in 4 foam trays and sealed box BV.FC1.



Code	Qty	Description
MODM.FLUO1-1	1	Foam module
PM.MODFLUO1-1	1	Foam tray
779.UVT	1	UV torch
834B.RTF	1	Inspection mirror
841F	1	Electricians scissors
EF.RF	1	Locking bit holder 1/4"
R.215RCF	1	1/4" locking extension Fluo
R.227AF	1	1/4" screwdriver handle 260 mm Fluo
R.4ELF	1	1/4" 12-point socket 4 mm Fluo
R.5.5ELF	1	1/4" 12-point socket 5.5 mm Fluo
R.5ELF	1	1/4" 12-point socket 5 mm Fluo
R.6ELF	1	1/4" 12-point socket 6 mm Fluo
R.7ELF	1	1/4" 12-point socket 7 mm Fluo
R.8ELF	1	1/4" 12-point socket 8 mm Fluo
R.9ELF	1	1/4" 12-point socket 9 mm Fluo
R.10ELF	1	1/4" 12-point socket 10 mm Fluo
R.11ELF	1	1/4" 12-point socket 11 mm Fluo
R.12ELF	1	1/4" 12-point socket 12 mm Fluo
R.13ELF	1	1/4" 12-point socket 13 mm Fluo
R.14ELF	1	1/4" 12-point socket 14 mm Fluo
R.3.2FLUO	1	1/4" 6-point socket 3.2 mm Fluo
R.4FLUO	1	1/4" 6-point socket 4 mm Fluo
R.5.5FLUO	1	1/4" 6-point socket 5.5 mm Fluo
R.5FLUO	1	1/4" 6-point socket 5 mm Fluo
R.6FLUO	1	1/4" 6-point socket 6mm Fluo
R.7FLUO	1	1/4" 6-point socket 7 mm Fluo
R.8FLUO	1	1/4" 6-point socket 8 mm Fluo
R.9FLUO	1	1/4" 6-point socket 9 mm Fluo
R.10FLUO	1	1/4" 6-point socket 10 mm Fluo
R.11FLUO	1	1/4" 6-point socket 11 mm Fluo
R.12FLUO	1	1/4" 6-point socket 12 mm Fluo
R.13FLUO	1	1/4" 6-point socket 13 mm Fluo
R.14FLUO	1	1/4" 6-point socket 14 mm Fluo
E.1063F	1	Set of 63 Detection Box bits
R.360F	1	1/4" 360° socket Fluo
MODM.FLUO1-2	1	Foam module
PM.MODFLUO1-2	1	Foam tray
113A.10CF	1	Chromed adjustable wrench 10" - Fluo
440.4HF	1	Combination wrench 4 mm Fluo
440.5.5HF	1	Combination wrench 5.5 mm Fluo
440.5HF	1	Combination wrench 5 mm Fluo

Code	Qty	Description
440.6F	1	Combination wrench 6 mm Fluo
440.7F	1	Combination wrench 7 mm
440.8F	1	Combination wrench 8 mm Fluo
440.9F	1	Combination wrench 9 mm Fluo
440.10F	1	Combination wrench 10 mm
440.11F	1	Combination wrench 11 mm
440.12F	1	Combination wrench 12 mm Fluo
440.13F	1	Combination wrench 13 mm Fluo
440.14F	1	Combination wrench 14 mm Fluo
440.16F	1	Combination wrench 16 mm Fluo
440.17F	1	Combination wrench 17 mm Fluo
440.18F	1	Combination wrench 18 mm Fluo
440.19F	1	Combination wrench 19 mm Fluo
MODM.FLUO1-3	1	Foam module
PM.MODFLUO1-3	1	Foam tray
170A.25F	1	Standard multigrip pliers - Fluo
185.20CPEF	1	Half-round long snipe-nose pliers
187.18CPEF	1	Combination pliers
192.16CPEF	1	Diagonal cutters
200C.30F	1	Graphite handle hammer
83SH.JP9F	1	9-piece set of hexagonal angled keys in wallet
AN2X75F	1	Protwist® screwdriver for slotted screws 4x35 Fluo
AN3.5X100F	1	Protwist® screwdriver for slotted screws 3.5x100 Fluo
AN3.5X75F	1	Protwist® screwdriver for slotted screws 3.5x75 Fluo
AN4X35F	1	Protwist® screwdriver for slotted screws 4X35 Fluo
DELA.1051.300	1	Stainless steel 2-sided rule
MODM.FLUO1-4	1	Foam module
PM.MODFLUO1-4	1	Foam tray
AN4X150F	1	Protwist® screwdriver for slotted screws 4x150 Fluo
AN5.5X150F	1	Protwist® screwdriver for slotted screws 5.5x100 Fluo
AN6.5X150F	1	Protwist® screwdriver for slotted screws 6.5x100 Fluo
ANPOX75F	1	Protwist® Phillips® screwdriver 0x75 Fluo
ANP1X100F	1	Protwist® Phillips® screwdriver 1x100 Fluo
ANP2X125F	1	Protwist® Phillips® screwdriver 2x125 Fluo
ANP3X150F	1	Protwist® Phillips® screwdriver 3x150 Fluo
ANP4X200F	1	Protwist® Phillips® screwdriver 4x200 Fluo
ANXR10X75F	1	Protwist® screwdriver for Resistorx® screws 10X75 Fluo
ANXR15X75F	1	Protwist® screwdriver for Resistorx® screws 15X75 Fluo
ANXR20X100F	1	Protwist® screwdriver for Resistorx® screws 20X100 Fluo
ANXR25X100F	1	Protwist® screwdriver for Resistorx® screws 25X100 Fluo



FLUO

Rfid

BVFC1.FLUO-2 136-piece set of inch fluorescent tools - foam trays and sealed box



- For all types of maintenance operations in locations requiring good visibility on the tooling.
- 2 Options available:
 - CM.AEFLUO-2: Set supplied without container.
 - BVFC1.FLUO-2: Set supplied in 4 foam trays and sealed box BV.FC1.



Qty	Description
1	MODM.FLUO2-1 Foam module
1	PM.MODFLUO2-1 Foam tray
1	440.1/2F Combination wrench 1/2"
1	440.11/16F Combination wrench 11/16" Fluo
1	440.13/16F Combination wrench 13/16" Fluo
1	440.15/16F Combination wrench 15/16" Fluo
1	440.1PF Combination wrench 1P Fluo
1	440.3/4F Combination wrench 3/4" Fluo
1	440.3/8F Combination wrench 3/8" Fluo
1	440.5/8F Combination wrench 5/8" Fluo
1	440.7/16F Combination wrench 7/16" Fluo
1	440.7/8F Combination wrench 7/8" Fluo
1	440.9/16F Combination wrench 9/16" Fluo
1	MODM.FLUO2-2 Foam module
1	PM.MODFLUO2-2 Foam tray
1	113A.6CF Chromed adjustable wrench 6" - Fluo
1	440.1/4F Combination wrench 1/4" Fluo
1	440.11/32F Combination wrench 11/32" Fluo
1	440.5/16F Combination wrench 5/16" Fluo
1	779.UVT UV torch
1	834B.RTF Inspection mirror
1	841F Electricians scissors
1	EF.RF Locking bit holder 1/4
1	R.215RCF 1/4" locking extension Fluo
1	R.227AF 1/4" screwdriver handle 260 mm Fluo
1	R.1/2EF 1/4" 12-point socket 1/2 Fluo
1	R.1/4EF 1/4" 12-point socket 1/4 Fluo
1	R.11/32EF 1/4" 12-point socket 11/32 Fluo
1	R.3/16EF 1/4" 12-point socket 3/16 Fluo
1	R.3/8EF 1/4" 12-point socket 3/8 Fluo
1	R.5/16EF 1/4" 12-point socket 5/16 Fluo
1	R.7/16EF 1/4" 12-point socket 7/16 Fluo
1	R.9/16EF 1/4" 12-point socket 9/16 Fluo
1	R.9/32EF 1/4" 12-point socket 9/32 Fluo
1	R.1/2ELF 1/4" long-reach 12-point socket 1/2 Fluo
1	R.1/4ELF 1/4" long-reach 12-point socket 11/32 Fluo

Qty	Description
1	R.11/32ELF 1/4" long-reach 12-point socket 11/32 Fluo
1	R.3/16ELF 1/4" long-reach 12-point socket 3/16 Fluo
1	R.3/8ELF 1/4" long-reach 12-point socket 3/8 Fluo
1	R.5/16ELF 1/4" long-reach 12-point socket 5/16 Fluo
1	R.7/16ELF 1/4" long-reach 12-point socket 7/16 Fluo
1	R.9/16ELF 1/4" long-reach 12-point socket 9/16 Fluo
1	R.9/32ELF 1/4" long-reach 12-point socket 9/32 Fluo
1	E.1063F Set of 63 Detection Box bits
1	R.360F 1/4" 360° socket Fluo
1	MODM.FLUO2-3 Foam module
1	PM.MODFLUO2-3 Foam tray
1	170A.25F Standard multigrip pliers - Fluo
1	185.20CPEF Half-round long snipe-nose pliers
1	187.18CPEF Combination pliers
1	192.16CPEF Diagonal cutters
1	200C.30F Graphite handle hammer
1	83SH.JP8UF 8-piece set of hexagonal angled keys in wallet
1	AN2X75F Protwist® screwdriver for slotted screws 4x35 Fluo
1	AN3.5X100F Protwist® screwdriver for slotted screws 3.5x100 Fluo
1	AN3.5X75F Protwist® screwdriver for slotted screws 3.5x75 Fluo
1	AN4X35F Protwist® screwdriver for slotted screws 4x35 Fluo
1	DELA.1051.300 Stainless steel 2-sided rule
1	MODM.FLUO2-4 Foam module
1	PM.MODFLUO2-4 Foam tray
1	ANPOX75F Protwist® Phillips® screwdriver 0x75 Fluo
1	ANP1X100F Protwist® Phillips® screwdriver 1x100 Fluo
1	ANP2X125F Protwist® Phillips® screwdriver 2x125 Fluo
1	ANP3X150F Protwist® Phillips® screwdriver 3x150 Fluo
1	ANP4X200F Protwist® Phillips® screwdriver 4x200 Fluo
1	ANXR10X75F Protwist® screwdriver for Resistorx® screws 10X75 Fluo
1	ANXR15X75F Protwist® screwdriver for Resistorx® screws 15X75 Fluo
1	ANXR20X100F Protwist® screwdriver for Resistorx® screws 20X100 Fluo
1	ANXR25X100F Protwist® screwdriver for Resistorx® screws 25X100 Fluo
1	AN4X150F Protwist® screwdriver for slotted screws 4x150 Fluo
1	AN5.5X150F Protwist® screwdriver for slotted screws 5.5x150 Fluo
1	AN6.5X150F Protwist® screwdriver for slotted screws 6.5x150 Fluo

COMBINATION WRENCHES FLUO

■ 440F - Metric combination wrenches - FLUO

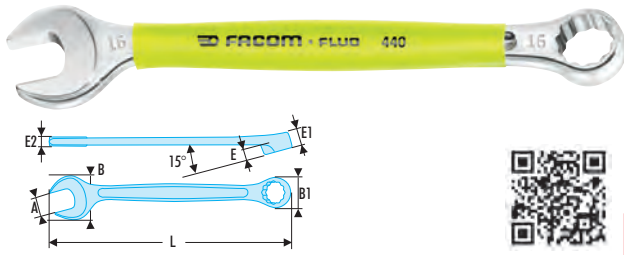

NF ISO 1711-1, NF ISO 691, ISO 1711-1, ISO 691, DIN ISO 1711-1, DIN ISO 691

- Detect the tool thanks to its fluorescence, activated by a lamp or UV neon light. Detectable in black or dark environment up to 5 meters.
- Standard wrench for all current applications.
- High mechanical strength combined with compact size meeting aeronautical standards.
- Ring head:
 - Ring open end (size E) designed for better access to series or embedded screws.
 - OGV® profile with 12-point ring for powerful tightening while protecting the nut. H suffix = 6-point ring.
 - Ring head angled at 15°.
- Open end head:
 - Open end angled at 15°.
 - Open end head-handle geometry optimised for increased access.
- Metric sizes: 4 to 19 mm.
- Presentation: satin chrome finish.

Size	A [mm]	B [mm]	B1 [mm]	E [mm]	E1 [mm]	E2 [mm]	L [mm]	ΔΔ [g]
440.4HF	4	10,0	7,8	2,1	3,5	3,0	106	10
440.5HF	5	13,3	9,2	3,1	6,0	3,6	115	15
440.5.5HF	5,5	13,3	9,2	3,1	6,0	3,8	115	15
440.6F	6	14,1	10,0	3,1	6,0	3,8	115	20
440.7F	7	17,2	11,2	3,4	6,2	3,9	122	20
440.8F	8	19,2	12,8	3,5	6,7	4,7	133	30
440.9F	9	21,2	14,2	3,9	7,1	4,7	138	35
440.10F	10	23,0	15,0	4,2	7,6	5,2	145	40
440.11F	11	24,5	16,9	4,6	8,1	5,5	155	50
440.12F	12	27,0	18,0	4,4	8,4	5,8	162	60
440.13F	13	28,7	19,3	4,8	8,6	6,1	170	70
440.14F	14	31,0	21,1	5,7	9,5	6,4	180	85
440.15F	15	32,6	22,2	5,9	10,0	6,8	185	95
440.16F	16	35,6	23,9	6,4	10,5	7,3	195	115
440.17F	17	37,0	25,3	6,5	10,9	7,6	202	130
440.18F	18	38,7	26,0	7,2	11,4	8,1	208	150
440.19F	19	41,2	27,8	7,2	11,9	8,3	216	170

■ 440F - Inch combination wrenches - FLUO

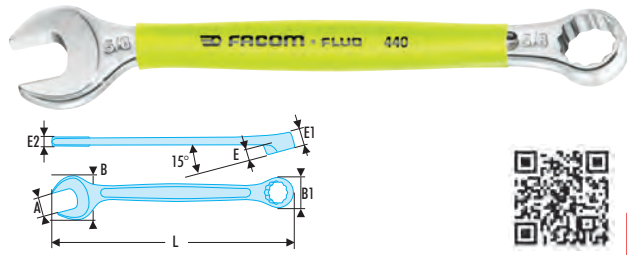

ASME B107.100, SAE AS954G

- Detect the tool thanks to its fluorescence, activated by a lamp or UV neon light. Detectable in black or dark environment up to 5 meters.
- Standard wrench for all current applications.
- High mechanical strength combined with compact size meeting aeronautical standards.
- Ring head:
 - Ring open end (size E) designed for better access to series or embedded screws.
 - OGV® profile with 12-point ring for powerful tightening while protecting the nut. H suffix = 6-point ring.
 - Ring head angled at 15°.
- Open end head:
 - Open end angled at 15°.
 - Open end head-handle geometry optimised for increased access.
- Dimensions in inches: from 1/4" to 1".
- Presentation: satin chrome finish.

Size	A ["]	B [mm]	B1 [mm]	E [mm]	E1 [mm]	E2 [mm]	L [mm]	ΔΔ [g]
440.1/4F	1/4	14,1	10,0	3,1	6,0	3,8	115	20
440.5/16F	5/16	19,2	12,8	3,5	6,7	4,7	133	30
440.11/32F	11/32	21,2	14,2	3,9	7,1	4,7	138	35
440.3/8F	3/8	23,0	15,0	4,2	7,6	5,2	145	45
440.7/16F	7/16	24,5	16,9	4,6	8,1	5,5	155	50
440.1/2F	1/2	28,7	19,3	4,8	8,6	6,1	170	70
440.9/16F	9/16	31,0	21,1	5,7	9,5	6,4	180	85
440.5/8F	5/8	35,6	23,9	6,4	10,5	7,3	195	115
440.11/16F	11/16	37,0	25,3	6,5	10,9	7,6	202	130
440.3/4F	3/4	41,2	27,8	7,2	11,9	8,3	216	170
440.13/16F	13/16	43,1	29,5	6,3	12,3	8,6	224	185
440.7/8F	7/8	46,9	32,3	8,3	13,3	9,0	248	230
440.15/16F	15/16	51,0	35,0	8,9	14,2	9,7	267	290
440.1PF	1	53,0	36,4	9,4	14,7	9,9	274	315

■ 39F - Inch short-reach combination wrenches - FLUO

ASME B107.100

- Detect the tool thanks to its fluorescence, activated by a lamp or UV neon light. Detectable in black or dark environment up to 5 meters.
- Short combination wrenches: the short handle and compact head allow for high handiness. Ideal for confined access.
- OGV® profile with 12-point ring for powerful tightening while protecting the nut. H suffix = 6-point ring.
- Ring head angled at 15°.
- Open end head angled at 15°.
- Dimensions in inches: from 1/8" to 1/2".
- Presentation: satin chrome finish.

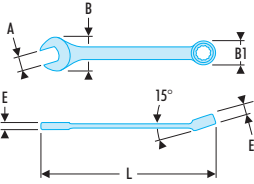

Size	A ["]	B [mm]	B1 [mm]	E [mm]	E1 [mm]	L [mm]	6+12 [mm]	ΔΔ [g]
39.1/8HF	1/8	10	7,0	3,1	3,1	77	6	10
39.5/32HF	5/32	10	8,0	3,1	3,1	77	6	10
39.3/16HF	3/16	11,8	9,0	3,5	4,0	82	6	10
39.7/32HF	7/32	11,8	9,5	3,5	4,0	84	6	10
39.1/4F	1/4	15	10,4	4,1	5,0	90	6	15
39.9/32F	9/32	15	11,5	4,1	5,0	90	6	15

Size	A ["]	B [mm]	B1 [mm]	E [mm]	E1 [mm]	L [mm]	6+12 [mm]	ΔΔ [g]
39.5/16F	5/16	17,2	12,5	4,5	5,8	94	6	20
39.11/32F	11/32	19,4	14	4,8	6,0	98	6	25
39.3/8F	3/8	21,5	15,3	5,1	6,4	103	6	30
39.7/16F	7/16	23,7	16,8	5,3	6,8	109	6	35
39.1/2F	1/2	28	19,5	5,8	8,0	141	12	50



FLUO

Rfid



RATCHET WRENCHES FLUO

64F - Inch straight ratchet ring wrenches - FLUO

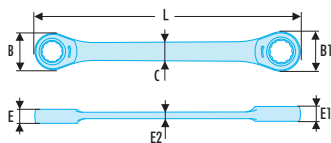

ASME B107.100

- Detect the tool thanks to its fluorescence, activated by a lamp or UV neon light. Detectable in black or dark environment up to 5 meters.
- Straight ratchet ring wrenches: to reach the nut flat.
- Compact ratchet mechanism and reversible by flipping the wrench.
- Increment 5° (7.5° for dimension 1/4" mm; 6° for dimensions 5/16" and 11/32").
- Dimensions in inches: from 1/4" to 5"16.
- Presentation: satin chrome finish.

⊞	A ["]	B1 [mm]	d [mm]	E [mm]	E1 [mm]	E2 [mm]	L [mm]	ΔΔ [g]
64.1/4X5/16F	1/4x5/16	17,2	8,0	6,3	6,5	3,0	115	40
64.5/16X11/32F	5/16x11/32	20,2	8,3	6,5	6,9	3,2	128	45
64.3/8X7/16F	3/8x7/16	21,8	9,1	7,3	7,7	3,6	150	60
64.1/2X9/16F	1/2x9/16	24,8	11,3	8,6	9,0	4,2	180	115
64.5/8X11/16F	5/8x11/16	33,5	14,8	9,9	10,7	5,4	210	185
64.3/4X13/16F	3/4x13/16	40,0	15,2	11,2	13,0	5,4	245	310
64.7/8X15/16F	7/8x15/16	46,0	15,2	13	14,5	5,4	260	480

65F - Metric 15° hinged ratchet ring wrenches - FLUO

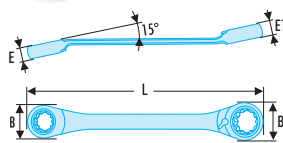

NF ISO 1711-1, NF ISO 691, ISO 1711-1, ISO 691, DIN ISO 1711-1, DIN ISO 691, ASME B107.100

- Detect the tool thanks to its fluorescence, activated by a lamp or UV neon light. Detectable in black or dark environment up to 5 meters.
- 15° hinged ratchet ring wrenches: ring offset to clear fingers or obstacles.
- Compact ratchet mechanism and reversible by lever.
- Increment 5° (7.5° for dimension 6 mm; 6° for dimensions 7, 8 and 9 mm).
- Ring head angled at 15°.
- Metric sizes: 6 to 24 mm.
- Presentation: satin chrome finish.

⊞	A [mm]	B [mm]	B1 [mm]	E [mm]	E1 [mm]	L [mm]	ΔΔ [g]
65.6X7F	6x7	14,0	17,0	6,3	6,5	115	30
65.8X9F	8x9	17,0	20,2	6,5	6,9	128	45
65.10X11F	10x11	20,2	22,0	7,3	7,7	150	65
65.12X13F	12x13	23,4	25,5	8,2	8,6	170	90
65.14X15F	14x15	26,9	29,8	9	9,4	190	130
65.16X18F	16x18	29,8	34,0	9,9	10,7	210	190
65.17X19F	17x19	31,8	34,0	10,3	11,2	230	210
65.21X23F	21x23	40,1	46,0	13	14,5	260	430
65.22X24F	22x24	40,1	46,5	13	14,5	260	425

OPEN END WRENCHES FLUO

34F - Inch 15° and 75° hinged "midget" open end wrenches - FLUO

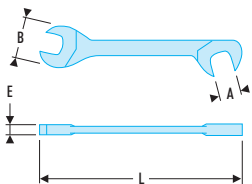

ASME B107.100, SAE AS954G

- Detect the tool thanks to its fluorescence, activated by a lamp or UV neon light. Detectable in black or dark environment up to 5 meters.
- "Midget" open end wrenches: short shank and slim heads for manoeuvrability in confined spaces.
- Heads hinged at 15° and 75° allow to intervene on nuts inaccessible with a standard wrench.
- Dimensions in inches: from 3/16" to 11/16".
- Presentation: satin chrome finish.



⊞	A ["]	B [mm]	E [mm]	L [mm]	ΔΔ [g]
34.3/16F	3/16	13	2,4	75	10
34.7/32F	7/32	13	2,4	75	10
34.1/4F	1/4	15	2,7	80	15
34.9/32F	9/32	15	2,7	80	15
34.5/16F	5/16	18,5	3,0	90	20
34.11/32F	11/32	18,5	3,0	90	20
34.3/8F	3/8	22	3,0	100	25

⊞	A ["]	B [mm]	E [mm]	L [mm]	ΔΔ [g]
34.13/32F	13/32	22	3,0	100	30
34.7/16F	7/16	22	3	100	30
34.1/2F	1/2	27	3,5	120	35
34.9/16F	9/16	27	3,5	120	40
34.5/8F	5/8	33	4,5	140	70
34.11/16F	11/16	33	4,5	140	70

■ 44F - Metric open end wrenches - FLUO

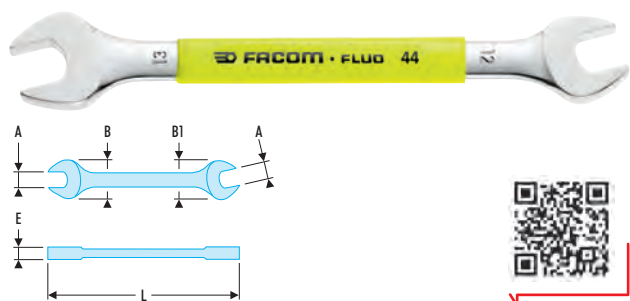

NF ISO 10102, NF ISO 3318, NF ISO 1711-1, NF ISO 691, ISO 10102, ISO 3318, ISO 1711-1, ISO 691, DIN ISO 1711-1, DIN ISO 691, DIN 3110

- Detect the tool thanks to its fluorescence, activated by a lamp or UV neon light. Detectable in black or dark environment up to 5 meters.
- Open end wrenches = the open ends are slimmer than a standard combination wrench for better thickness accessibility. Examples: brake calipers, hydraulic hose locknuts.
- Heads hinged at 15°.
- Metric sizes: 3.2 to 30 mm.
- Presentation: satin chrome finish.

🔧	A [mm]	B x B1 [mm]	E [mm]	L [mm]	ΔΔ [g]
44.3.2X5.5F	3,2x5,5	11,0 x 13,5	3,0	90	10
44.4X5F	4x5	11,0 x 13,5	3,0	90	10
44.6X7F	6x7	15,0 x 17,5	3,5	120	20
44.8X9F	8x9	18,5 x 21,0	3,8	137	30
44.8X10F	8x10	19,0 x 23,0	4,2	143	40
44.10X11F	10x11	23,0 x 25,0	4,7	152	50
44.10X13F	10x13	23,0 x 29,0	5,1	162	60
44.12X13F	12x13	25,5 x 29,0	5,1	167	65
44.12X14F	12x14	29,0 x 33,5	5,5	177	80
44.13X17F	13x17	31,0 x 37,0	6,3	192	120
44.14X15F	14x15	31,0 x 33,0	5,5	182	90
44.16X17F	16x17	35,5 x 37,0	6,3	200	120
44.16X18F	16x18	37,0 x 42,0	6,8	210	145
44.17X19F	17x19	37,0 x 42,0	6,8	210	145
44.18X19F	18x19	39,0 x 42,0	7,3	220	160
44.20X22F	20x22	43,0 x 48,5	7,5	240	200
44.26X28F	26x28	56,0 x 61,6	8,8	282	360
44.27X29F	27x29	59,0 x 64,0	9,5	301	450
44.27X30F	27x30	59,0 x 64,0	9,5	301	450

■ 44F - Inch open end wrenches - FLUO

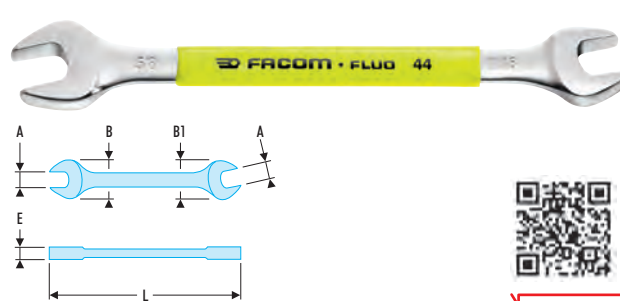

ASME B107.100

- Detect the tool thanks to its fluorescence, activated by a lamp or UV neon light. Detectable in black or dark environment up to 5 meters.
- Open end wrenches = the open ends are slimmer than a standard combination wrench for better thickness accessibility. Examples: brake calipers, hydraulic hose locknuts.
- Heads hinged at 15°.
- Dimensions in inches: from 1/4" to 11/16".
- Presentation: satin chrome finish.

🔧	A ["]	B x B1 [mm]	E [mm]	L [mm]	ΔΔ [g]
44.1/4X5/16F	1/4x5/16	15,0 x 17,5	3,5	120	20
44.11/32X13/32F	11/32x13/32	19,0 x 23,0	4,2	143	40
44.3/8X7/16F	3/8x7/16	23,0 x 25,0	4,7	152	50
44.1/2X9/16F	1/2x9/16	29,0 x 33,5	5,5	177	80
44.5/8X11/16F	5/8x11/16	37,0 x 42,0	6,8	210	145
44.3/4X13/16F	3/4x13/16	43,0 x 48,5	7,5	240	200
44.1PX1P1/16F	1"X1"1/16	56,0 x 61,6	8,8	282	360
44.1P1/8X1P1/4F	1"1/8X1"1/4	63,0 x 70,0	9,8	318	515
44.1P3/8X1P1/2F	1"3/8X1"1/2	78,0 x 87,0	12	381	945
44.7/8X15/16F	7/8X15/16	47,5 x 52,0	8,3	251	260

VARIABLE OPENING WRENCHES FLUO

■ 113A.CF - Chromed adjustable wrenches - FLUO

NF ISO 6787, ISO 6787, DIN 3117, ASME B107.100

- Detect the tool thanks to its fluorescence, activated by a lamp or UV neon light. Detectable in black or dark environment up to 5 meters.
- Good access to the button = easy setting.
- Non-protruding moving jaw at maximum capacity.
- Pre-adjustment of jaw opening thanks to millimetric gradation.
- Right-hand button rotation.
- Range from 4" to 12".
- Presentation: chromed body and polished head faces.

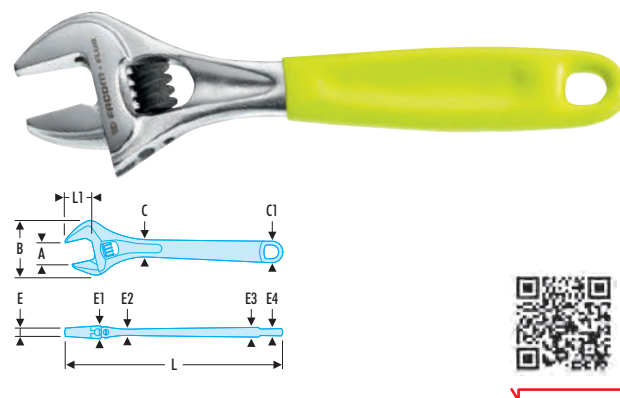

🔧	A [mm]	B [mm]	C x C1 [mm]	E [mm]	E1 [mm]	E2 [mm]	E3 [mm]	E4 [mm]	L [mm]	L1 [mm]	ΔΔ [g]
113A.4CF	13	34,0	11,0 x 14,0	14	9,5	5,0	6,5	5,0	114	13	65
113A.6CF	20	45,0	14,8 x 18,5	18,5	11,8	6,0	8,3	5,8	155	19	125
113A.10CF	30	69,5	21,5 x 28,5	28,5	15,5	9,5	12,7	10,0	255	29	480
113A.12CF	34	80,0	25,0 x 31,0	31	18,0	10,2	13,0	10,0	306	34	700



FLUO

Rfid

SOCKET WRENCHES FLUO

74AF - Forged socket wrenches with metric screwdriver handle - FLUO

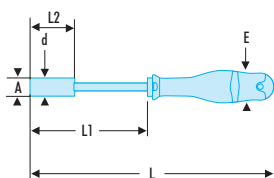

NF ISO 2236, NF ISO 691, ISO 2236, ISO 691, DIN 3125, DIN ISO 691

- Detect the tool thanks to its fluorescence, activated by a lamp or UV neon light. Detectable in black or dark environment up to 5 meters.
- Socket wrenches with screwdriver handle ideal for screws with limited access in height or precision mechanics.
- Protwist screwdriver handle for optimum comfort even for powerful unlocking.
- 6-point socket with deep opening for long threads.
- Forged body for maximum strength.
- Metric sizes: 3.2 to 14 mm.
- Presentation: satin chrome finish.

ED	A [mm]	d1 [mm]	E [mm]	L [mm]	L1 [mm]	L2 [mm]	ΔΔ [g]
74A.3.2F	3,2	6,0	36	245	125	20	110
74A.4F	4,0	7,0	36	245	125	20	115
74A.4.5F	4,5	7,5	36	245	125	25	120
74A.5F	5,0	8,0	36	245	125	25	120
74A.5.5F	5,5	8,0	36	245	125	30	120
74A.6F	6,0	9,5	36	245	125	35	125
74A.7F	7,0	9,5	36	245	125	35	130
74A.8F	8,0	12,0	36	245	125	50	155
74A.9F	9,0	12,0	36	245	125	50	160
74A.10F	10,0	14,5	40	250	125	50	200
74A.11F	11,0	16,0	40	250	125	50	210
74A.12F	12,0	17,0	40	250	125	50	210
74A.13F	13,0	18,5	40	250	125	55	250
74A.14F	14,0	20,0	40	250	125	55	255

RATCHETS 1/4" FLUO

1/4" Hi-Lok® ratchet - FLUO

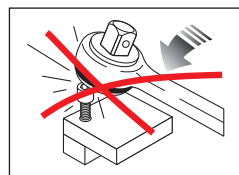
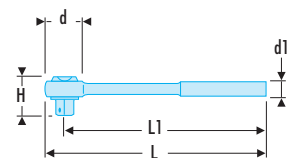

ISO 3315

- Detect the tool thanks to its fluorescence, activated by a lamp or UV neon light. Detectable in black or dark environment up to 5 meters.
- Specific ratchet for use on Hi-Lok®, Hi-Lite® or Hi-Tigue® rivets.
- The sockets are locked onto square drive by a metal clip.
- Hole in the ratchet head to insert a key to lock the fastener during the tightening phase.
- Highly compact head for better accessibility.
- 1/4" square drive bit.
- 72 tooth mechanism for 5° increments.
- Detect the tool thanks to its fluorescence, activated by a lamp or UV neon light. Detectable in black or dark environment up to 5 metres.

ED	d [mm]	d1 [mm]	L [mm]	L1 [mm]	ΔΔ [g]
RL.161HLF	22	20	120	110	80

1/4" maintenance free pear head locking ratchet - FLUO

NF ISO 3315, ISO 3315, DIN 3122, ASME B107.10

- Detect the tool thanks to its fluorescence, activated by a lamp or UV neon light. Detectable in black or dark environment up to 5 meters.
- Socket locking and quick release system.
- Dust proof, maintenance free mechanism.
- 72 teeth mechanism for 5° increments.
- Drive direction switch allows easy reversal even with gloved or greasy hands.
- Palm control system - allows the operator to press down on the head avoiding risk of accidental reverse
- Ultra-compact head.
- Hook for hanging when working at height.
- Ergonomic comfort grip handle design resistant to workshop chemicals and solvents.

FLUO	d [mm]	d1 [mm]	H [mm]	L [mm]	L1 [mm]	ΔΔ [g]
RL.171F	22	78	20	120	25	110

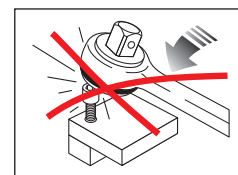
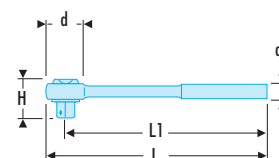

1/4" fast ratchet with rotating handle - FLUO

- Detect the tool thanks to its fluorescence, activated by a lamp or UV neon light. Detectable in black or dark environment up to 5 meters.
- Rotating handle mechanism: work twice faster in confined spaces.
- 60 tooth mechanism for 6° increments upon final tightening.
- Socket safety locking: no sockets lost in your machines.
- Reversing by rotating cap.
- "Palm control" system, allowing to press the ratchet head during (un)tightening without risk of accidental reversing of the rotation direction.
- Bi-material elastomer grip: high resistance to abrasion and the most severe workshop solvents: SP95, SP98, diesel fuel, acetone, brake fluid, Skydrol, Jet Oil, kerosene.

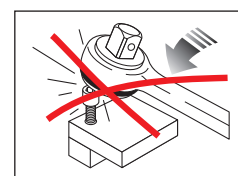
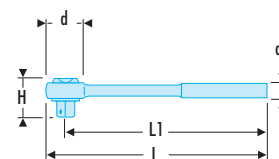

FLUO	d [mm]	d1 [mm]	H [mm]	L [mm]	L1 [mm]	ΔΔ [g]
R.360F	27	21	29	120	120	160



FLUO

Rfid

RATCHETS 1/4" FLUO

1/4" drive locking extensions - FLUO



NF ISO 3316, ISO 3316, DIN 3123, ASME B107.10

- Detect the tool thanks to its fluorescence, activated by a lamp or UV neon light. Detectable in black or dark environment up to 5 meters.
- Locking mechanism.
- Finish: bright chrome.



REF	d [mm]	d1 [mm]	d2 [mm]	L [mm]	ΔΔ [g]
R.210RCF	8,2	12	13	100	45
R.215RCF	8,2	12	13	150	60
R.217RCF	8,2	12	13	250	100

Bit-holder ratchet wrench 1/4" - 5/16" - FLUO



- Detect the tool thanks to its fluorescence, activated by a lamp or UV neon light. Detectable in black or dark environment up to 5 meters.
- Takes the following bits:
 - Series 1: hexagon 1/4".
 - Series 2: hexagon 5/16".
- Used for installing 1/4" and 5/16" aircraft fasteners.
- Increment: 5°.
- Heads angled at 15°.
- Bits held by a spring clip.
- Knurled head for fast pre-tightening.
- Length 150 mm.
- Satin chrome finish.



REF	L [mm]	ΔΔ [g]
65.PEF	150	74

1/4" drive short spinner - FLUO



NF ISO 3315, ISO 3315, DIN 3122, ASME B107.10

- Detect the tool thanks to its fluorescence, activated by a lamp or UV neon light. Detectable in black or dark environment up to 5 meters.
- Ergonomic bi-material grip.
- Ideal for confined spaces.



REF	ΔΔ [g]
R.236CF	76

1/4" drive medium spinner - FLUO



NF ISO 3315, ISO 3315, DIN 3122, ASME B107.10

- Detect the tool thanks to its fluorescence, activated by a lamp or UV neon light. Detectable in black or dark environment up to 5 meters.
- Ergonomic bi-material grip.
- Ideal for confined spaces.



REF	ΔΔ [g]
R.236AF	79

1/4" drive standard spinner - FLUO

NF ISO 3315, ISO 3315, DIN 3122, ASME B107.10

- Detect the tool thanks to its fluorescence, activated by a lamp or UV neon light. Detectable in black or dark environment up to 5 meters.
- Ergonomic bi-material grip.
- Ideal for confined spaces.

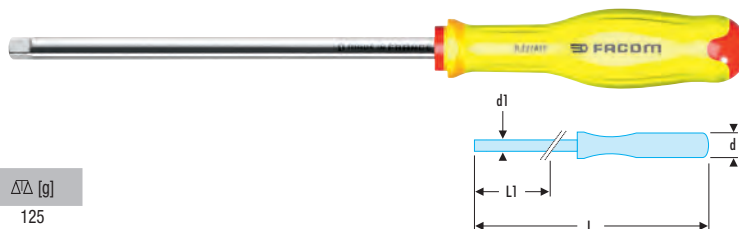

REF	d [mm]	d1 [mm]	L [mm]	L1 [mm]	ΔΔ [g]
R.227AF	23,5	8	260	160	125

1/4" to 3/8" coupler - FLUO

NF ISO 3316, ISO 3316, DIN 3123, ASME B107.10

- Detect the tool thanks to its fluorescence, activated by a lamp or UV neon light. Detectable in black or dark environment up to 5 meters.
- 1/4" female to 3/8" male square drive.
- For adapting 3/8" drive sockets.
- Finish: bright chrome.



REF	d [mm]	d1 [mm]	L [mm]	L1 [mm]	ΔΔ [g]
R.232F	12	12	24,5	13,5	16

1/4" drive standard spring-clip bit holder - FLUO

NF ISO 1173, ISO 1173

- Detect the tool thanks to its fluorescence, activated by a lamp or UV neon light. Detectable in black or dark environment up to 5 meters.
- Spring clip for frequent bit changes.
- Finish: bright chrome.



REF	A ["]	d [mm]	L [mm]	ΔΔ [g]
R.235F	1/4	11,3	22	10

SOCKETS 1/4" FLUO

R.FLUO 1/4" drive metric 6-point sockets - FLUO

NF ISO 2725-1, NF ISO 1711-1, ISO 2725-1, ISO 1711-1, DIN 3124, ASME B107.5

- Detect the tool thanks to its fluorescence, activated by a lamp or UV neon light. Detectable in black or dark environment up to 5 meters.
- OGV® profile: more powerful tightening, preserves fasteners.
- Finish: bright chrome.
- Available as sets on metal rack (Ref R.40E).



REF	A [mm]	d [mm]	d1 [mm]	L [mm]	L1 [mm]	ΔΔ [g]
R.3.2FLUO	3,2	11,2	5,9	22	2,4	10
R.4FLUO	4,0	11,2	6,9	22	2,6	10
R.5FLUO	5,0	11,2	8,2	22	4,8	10
R.5.5FLUO	5,5	11,2	8,8	22	4,8	10
R.6FLUO	6,0	11,2	9,4	22	5,6	10
R.7FLUO	7,0	11,0	11,0	22	6,0	10
R.8FLUO	8,0	12,0	12,0	22	6,5	10

REF	A [mm]	d [mm]	d1 [mm]	L [mm]	L1 [mm]	ΔΔ [g]
R.9FLUO	9,0	13,2	13,2	22	6,5	15
R.10FLUO	10,0	14,7	14,7	22	7,8	20
R.11FLUO	11,0	15,8	15,8	22	9,0	20
R.12FLUO	12,0	17,0	17,0	22	9,50	25
R.13FLUO	13,0	17,7	17,7	22	10,00	25
R.14FLUO	14,0	18,7	18,7	22	10,00	30



FLUO

Rfid

SOCKETS 1/4" FLUO

R 1/4" drive inch 6-point sockets - FLUO

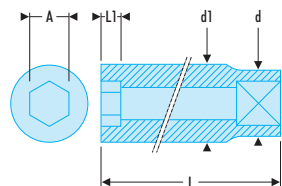

ASME B107.1

- Detect the tool thanks to its fluorescence, activated by a lamp or UV neon light. Detectable in black or dark environment up to 5 meters.
- OGV® profile: more powerful tightening, preserves fasteners.
- Finish: bright chrome.

➤	A ["]	d [mm]	d1 [mm]	L [mm]	L1 [mm]	⚙ [mm]	ΔΔ [g]
R.3/16FLUO	3/16	11,2	8,0	22	4,75		10
R.7/32FLUO	7/32	11,2	9,0	22	5,50		10
R.1/4FLUO	1/4	11,2	10,1	22	6,00		10
R.9/32FLUO	9/32	11,0	11,0	22	6,00		10
R.5/16FLUO	5/16	12,0	12,0	22	6,50		15
R.11/32FLUO	11/32	13,2	13,2	22	6,50		20
R.3/8FLUO	3/8	14,7	14,7	22	7,80		20
R.13/32FLUO	13/32	14,7	14,7	22	7,80		20
R.7/16FLUO	7/16	15,8	15,8	22	9,00		20
R.1/2FLUO	1/2	17,7	17,7	22	10,00		25
R.9/16FLUO	9/16	18,7	18,7	22	10,00		25

R.EF 1/4" drive inch 12-point sockets - FLUO

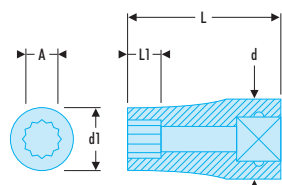

ASME B107.1

- Detect the tool thanks to its fluorescence, activated by a lamp or UV neon light. Detectable in black or dark environment up to 5 meters.
- OGV® profile: more powerful tightening, preserves fasteners.
- Finish: bright chrome.

➤	A ["]	d [mm]	d1 [mm]	d3 [mm]	H [mm]	L [mm]	L1 [mm]	L2 [mm]	⚙ [mm]	ΔΔ [g]
R.3/16EF	3/16	11,2	8,0	8,20	8,0	22	4,75	4,75	12	10
R.7/32EF	7/32	11,2	9,0	8,30	9,0	22	5,50	5,50	12	10
R.1/4EF	1/4	11,2	10,1	9,30	10,1	22	6,00	6,00	12	10
R.9/32EF	9/32	11,2	10,6	8,90	10,6	22	6,00	6,00	12	10
R.5/16EF	5/16	12,0	12,0	11,50	12,0	22	6,50	6,50	12	10
R.11/32EF	11/32	13,0	13,0	14,50	13,0	22	6,50	6,50	12	15
R.3/8EF	3/8	14,7	14,7	17,80	14,7	22	7,80	7,80	12	18
R.13/32EF	13/32	14,7	14,7	17,00	14,7	22	7,80	7,80	12	20
R.7/16EF	7/16	15,8	15,8	19,5	15,8	22	9,00	9,00	12	20
R.1/2EF	1/2	17,7	17,7	24,5	17,7	22	10,00	10,00	12	25
R.9/16EF	9/16	18,7	18,7	25,20	18,7	22	10,00	10,00	12	25

11-piece rack set of 1/4" long-reach inch 12-point sockets - FLUO



- Detect the tool thanks to its fluorescence, activated by a lamp or UV neon light. Detectable in black or dark environment up to 5 meters.
- 11 sockets : 3/16" - 7/32" - 1/4" - 9/32" - 5/16" - 11/32" - 3/8" - 13/32" - 7/16" - 1/2" - 9/16".
- Supplied on metal rack.

➤	ΔΔ [g]
REL.40UF	345

■ R.ELF - 1/4" long-reach metric 12-point sockets - FLUO

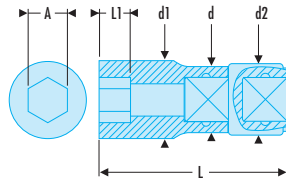

■ R.ELF 1/4" long-reach metric 12-point sockets - FLUO

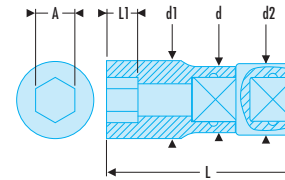

NF ISO 2725-1, NF ISO 1711-1, ISO 2725-1, ISO 1711-1, DIN 3124, ASME B107.5

- Detect the tool thanks to its fluorescence, activated by a lamp or UV neon light. Detectable in black or dark environment up to 5 meters.
- OGV® profile: more powerful tightening, preserves fasteners.
- Long-reach sockets for long recess or thread access.
- Available as rack sets (Ref REL.40U).
- Finish: bright chrome.

Socket	A [mm]	d [mm]	d1 [mm]	L [mm]	L1 [mm]	⚙️ [mm]	ΔΔ [g]
R.4ELF	4	6,7	11,2	50	4	12	18
R.4.5ELF	4,5	7,3	11,2	50	4,5	12	18
R.5ELF	5	7,8	11,2	50	5,5	12	18
R.5.5ELF	5,5	8,5	11,2	50	6	12	18
R.6ELF	6	9,2	11,2	50	7	12	18
R.7ELF	7	10,3	11,2	50	8	12	27
R.8ELF	8	11,2	11,7	50	9	12	27
R.9ELF	9	13	12	50	10	12	32
R.10ELF	10	14,3	12,9	50	11	12	41
R.11ELF	11	15,5	14,3	50	12	12	54
R.12ELF	12	16,8	15,5	50	13	12	56
R.13ELF	13	18	16,4	50	14	12	59
R.14ELF	14	19,3	17,9	50	16	12	68

ASME B107.1

- Detect the tool thanks to its fluorescence, activated by a lamp or UV neon light. Detectable in black or dark environment up to 5 meters.
- OGV® profile: more powerful tightening, preserves fasteners.
- Long-reach sockets for long recess or thread access.
- High performance, suitable for aircraft fasteners to AS954E.
- Thinner socket walls for better accessibility.
- Finish: bright chrome.

Socket	A ["]	d [mm]	d1 [mm]	L [mm]	L1 [mm]	⚙️ [mm]	ΔΔ [g]
R.3/16ELF	3/16	10,9	7,7	50	6,0	12	14
R.7/32ELF	7/32	10,9	8,5	50	7,4	12	15
R.1/4ELF	1/4	10,9	9,4	50	7,4	12	17
R.9/32ELF	9/32	10,9	10,2	50	8,5	12	17
R.5/16ELF	5/16	11,8	11,4	50	9,0	12	23
R.11/32ELF	11/32	12,0	12,5	50	9,7	12	25
R.3/8ELF	3/8	12,8	13,7	50	11,2	12	32
R.7/16ELF	7/16	14,3	15,6	50	11,9	12	40
R.1/2ELF	1/2	16,2	17,3	50	13,8	12	45
R.9/16ELF	9/16	17,1	18,8	50	16,2	12	49

RATCHETS 3/8" FLUO

■ 3/8" Hi-Lok® ratchet - FLUO

ISO 3315

- Detect the tool thanks to its fluorescence, activated by a lamp or UV neon light. Detectable in black or dark environment up to 5 meters.
- Specific ratchet for use on Hi-Lok®, Hi-Lite® or Hi-Tigue® rivets.
- The sockets are locked onto square drive by a metal clip.
- Hole in the ratchet head to insert a key to lock the fastener during the tightening phase.
- Highly compact head for better accessibility.
- 3/8" square drive bit.
- 72 tooth mechanism for 5° increments.

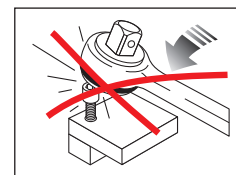
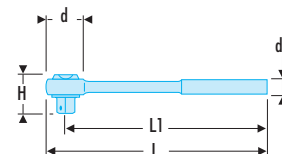

Socket	d [mm]	d1 [mm]	H [mm]	L [mm]	L1 [mm]	ΔΔ [g]
JL.161HLF	29	27	29	210	195	200

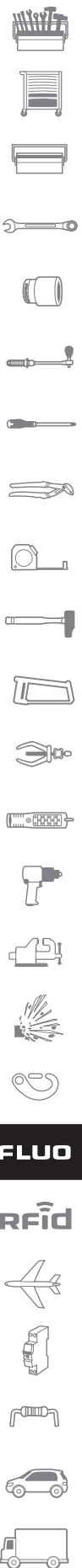

FLUO

RFid

RATCHETS 3/8" FLUO

3/8" maintenance free pear head locking ratchet - FLUO

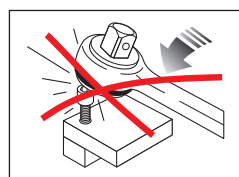
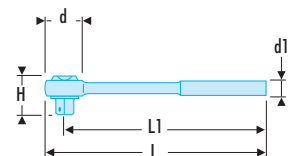

NF ISO 3315, ISO 3315, DIN 3122, ASME B107.10

- Detect the tool thanks to its fluorescence, activated by a lamp or UV neon light. Detectable in black or dark environment up to 5 meters.
- Socket locking and quick release system.
- Dust proof, maintenance free mechanism.
- 72 teeth mechanism for 5° increments.
- Drive direction switch allows easy reversal even with gloved or greasy hands.
- Palm control system - allows the operator to press down on the head avoiding risk of accidental reverse
- Ultra-compact head.
- Hook for hanging when working at height.
- Ergonomic comfort grip handle design resistant to workshop chemicals and solvents.

ED	d [mm]	d1 [mm]	H [mm]	L [mm]	L1 [mm]	ΔΔ [g]
JL.171F	29	27	27	210	195	200

SOCKETS 3/8" FLUO

J.FLUO- 3/8" inch 12-point sockets - FLUO

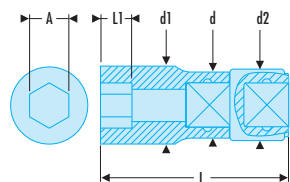

ASME B107.1

- Detect the tool thanks to its fluorescence, activated by a lamp or UV neon light. Detectable in black or dark environment up to 5 meters.
- OGV® profile: more powerful tightening, preserves fasteners.
- Available as rack sets (Ref J.40U).
- Finish: bright chrome.

ED	A ["]	d [mm]	d1 [mm]	L [mm]	L1 [mm]	12 [mm]	ΔΔ [g]
J.1/4FLUO	1/4	17,5	10,0	27	6,0	12	24
J.5/16FLUO	5/16	17,5	11,9	27	6,5	12	25
J.3/8FLUO	3/8	17,6	14,1	27	7,5	12	26
J.7/16FLUO	7/16	17,5	16,0	27	9,0	12	27
J.1/2FLUO	1/2	17,5	18,1	30	10,4	12	36
J.9/16FLUO	9/16	17,7	19,5	30	10,5	12	34

ED	A ["]	d [mm]	d1 [mm]	L [mm]	L1 [mm]	12 [mm]	ΔΔ [g]
J.5/8FLUO	5/8	20,0	22,0	30	12,0	12	46
J.11/16FLUO	11/16	21,0	24,0	33	13,0	12	74
J.3/4FLUO	3/4	22,7	26,0	33	14,0	12	76
J.13/16FLUO	13/16	23,0	28,0	33	16,0	12	79
J.7/8FLUO	7/8	24,7	29,7	33	16,5	12	104

■ J.LAF - 3/8" inch 12-point sockets - FLUO



ASME B107.1

- Detect the tool thanks to its fluorescence, activated by a lamp or UV neon light. Detectable in black or dark environment up to 5 meters.
- OGV® profile: more powerful tightening, preserves fasteners.
- Long-reach sockets for long recess or thread access.
- Finish: bright chrome.

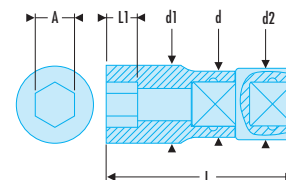

⊞	A ["]	d [mm]	d1 [mm]	L [mm]	L1 [mm]	12 [mm]	ΔΔ [g]
J.1/4LAF	1/4	17,5	10,6	44,7	4,0	12	36
J.5/16LAF	5/16	17,5	12,4	44,7	4,3	12	36
J.3/8LAF	3/8	17,5	14,3	44,7	4,7	12	41
J.7/16LAF	7/16	17,5	16,2	44,7	6,2	12	45
J.1/2LAF	1/2	18,2	18,2	44,7	7,4	12	50
J.9/16LAF	9/16	20,5	20,5	48,0	9,0	12	72

⊞	A ["]	d [mm]	d1 [mm]	L [mm]	L1 [mm]	12 [mm]	ΔΔ [g]
J.5/8LAF	5/8	22,3	22,3	63,8	10,2	12	104
J.11/16LAF	11/16	23,8	23,8	63,8	10,2	12	113
J.3/4LAF	3/4	25,3	25,3	63,8	11,8	12	127
J.13/16LAF	13/16	27,0	27,0	63,8	12,3	12	140
J.7/8LAF	7/8	30,2	30,2	63,8	12,7	12	181

STANDARD 1/2" RANGE FLUO

■ 1/2" Hi-Lok® ratchet - FLUO



ISO 33151

- Detect the tool thanks to its fluorescence, activated by a lamp or UV neon light. Detectable in black or dark environment up to 5 meters.
- Specific ratchet for use on Hi-Lok®, Hi-Lite® or Hi-Tigue® rivets.
- The sockets are locked onto square drive by a metal clip.
- Hole in the ratchet head to insert a key to lock the fastener during the tightening phase.
- Highly compact head for better accessibility.
- 1/2" square drive bit.
- 72 tooth mechanism for 5° increments.

⊞	d [mm]	d1 [mm]	H [mm]	L [mm]	L1 [mm]	ΔΔ [g]
SL.161HLF	37	32	37	262	245	446

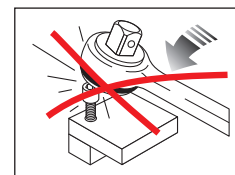
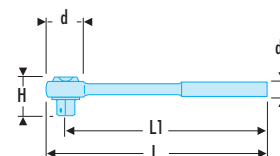

FLUO

Rfid

PROTWIST® SCREWDRIVER FLUO

■ ANF - PROTWIST® screwdrivers for slotted head screws - milled blades - FLUO

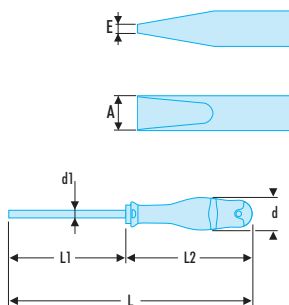

■ AWF - PROTWIST® screwdrivers for slotted head screws - hexagonal blades - FLUO

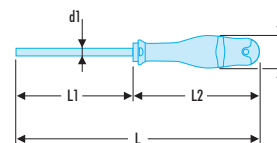

NF ISO 2380-1, NF ISO 2380-2, ISO 2380-1, ISO 2380-2, DIN ISO 2380-1, DIN ISO 2380-2, ASME B107.600

- Detect the tool thanks to its fluorescence, activated by a lamp or UV neon light. Detectable in black or dark environment up to 5 meters.
- Round shank for access in wells.
- Extra-long shank up to 300 mm for difficult and remote access.
- Silicon carbon blade: strong and resistant to flexion.
- Bi-material grip resists to impacts, abrasion, and chemicals.

ED	A [mm]	d [mm]	d1 x L1 [mm]	E [mm]	L [mm]	L2 [mm]	ΔΔ [g]
AN2X75F	2,0	19	2,0 x 75	0,4	169	94	18
AN2.5X75F	2,5	19	2,5 x 75	0,4	169	94	21
AN3X75F	3,5	25	3,5 x 75	0,6	178	103	41
AN3.5X75F	3,5	25	3,5 x 75	0,6	178	103	41
AN3X100F	3,0	25	3,0 x 100	0,5	203	103	33
AN3.5X100F	3,5	25	3,5 x 100	0,6	203	103	43
AN4X35F	4,0	36	4,0 x 35	0,8	91	56	36
AN4X100F	4,0	30	4,0 x 100	0,8	209	109	47
AN4X150F	4,0	30	4,0 x 150	0,8	259	109	52
AN5.5X100F	5,5	30	5,5 x 100	1,0	209	109	82
AN5.5X150F	5,5	30	5,5 x 150	1,0	259	109	91
AN6.5X35F	6,5	36	6,5 x 35	1,2	91	56	46
AN6.5X150F	6,5	36	6,5 x 150	1,2	270	120	140

NF ISO 2380-1, NF ISO 2380-2, ISO 2380-1, ISO 2380-2, DIN ISO 2380-1, DIN ISO 2380-2, ASME B107.600

- Detect the tool thanks to its fluorescence, activated by a lamp or UV neon light. Detectable in black or dark environment up to 5 meters.
- Hexagonal blade for optimum reliability and performance.
- Extra-long shank up to 200 mm for difficult and remote access.
- Silicon carbon blade: strong and resistant to flexion.
- Bi-material grip resists to impacts, abrasion, and chemicals.

ED	d [mm]	d1 x L1 [mm]	L [mm]	L2 [mm]	ΔΔ [g]
AW8X150F	40	7 x 150	275	125	220
AW10X200F	40	9 x 200	325	125	255

■ **ANPF - PROTWIST® screwdrivers for Phillips® screws - round blades - FLUO**

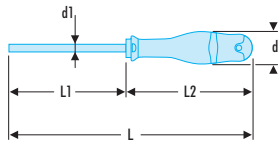

NF ISO 8764-1, NF ISO 8764-2, ISO 8764-1, ISO 8764-2, DIN ISO 8764-1, DIN ISO 8764-2, ASME B107.600

- Detect the tool thanks to its fluorescence, activated by a lamp or UV neon light. Detectable in black or dark environment up to 5 meters.
- Extra-long blade up to 400 mm for difficult and remote access.
- Silicon carbon blade: strong and resistant to flexion.
- Bi-material grip resists to impacts, abrasion, and chemicals.

🔪	d [mm]	d1 x L1 [mm]	L [mm]	L2 [mm]	Phillips [No]	ΔΔ [g]
ANPOX75F	25	3,0 x 75	178	103	PH0	45
ANP1X35F	36	4,5 x 35	91	56	PH1	39
ANP1X100F	30	4,5 x 100	209	109	PH1	76
ANP2X35F	36	6,0 x 35	91	56	PH2	44
ANP2X125F	36	6,0 x 125	245	120	PH2	126
ANP2X250F	36	6,0 x 250	370	120	PH2	153
ANP2X400F	36	6,0 x 400	520	120	PH2	186
ANP3X150F	40	8,0 x 150	275	125	PH3	194
ANP4X200F	30	10,0 x 200	325	109	PH4	277

■ **AWPF - PROTWIST® screwdrivers for Phillips® screws - hexagonal blades - FLUO**

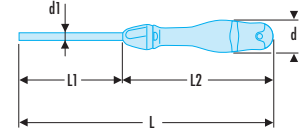
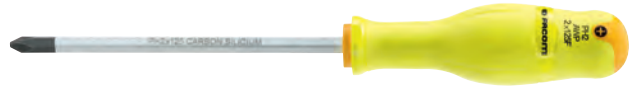

NF ISO 8764-1, NF ISO 8764-2, ISO 8764-1, ISO 8764-2, DIN ISO 8764-1, DIN ISO 8764-2, ASME B107.600

- Detect the tool thanks to its fluorescence, activated by a lamp or UV neon light. Detectable in black or dark environment up to 5 meters.
- Hexagonal blade for optimum reliability and performance.
- Silicon carbon blade: strong and resistant to flexion.
- Bi-material grip resists to impacts, abrasion, and chemicals.
- Finish: black tipped mat chromed blade.

🔪	d [mm]	d1 x L1 [mm]	L [mm]	L2 [mm]	Phillips [No]	ΔΔ [g]
AWP2X125F	36	6 x 125	245	120	PH2	130

■ **ANDF - PROTWIST® screwdrivers for Pozidriv® screws - round blades - FLUO**

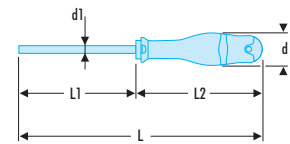
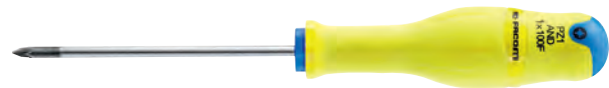

NF ISO 8764-1, NF ISO 8764-2, ISO 8764-1, ISO 8764-2, DIN ISO 8764-1, DIN ISO 8764-2, ASME B107.600

- Detect the tool thanks to its fluorescence, activated by a lamp or UV neon light. Detectable in black or dark environment up to 5 meters.
- Silicon carbon blade: strong and resistant to flexion.
- Bi-material grip resists to impacts, abrasion, and chemicals.
- Finish: black tipped mat chromed round blade.

🔪	d [mm]	d1 x L1 [mm]	L [mm]	L2 [mm]	Pozidriv [No]	ΔΔ [g]
ANDOX75F	25	3,0 x 75	178	103	PZ0	45
AND1X100F	30	4,5 x 100	209	109	PZ1	76
AND2X125F	36	6,0 x 125	245	120	PZ2	126
AND3X150F	40	8,0 x 150	275	125	PZ3	194
AND1X35F	36	4,5 x 35	91	56	PZ1	40
AND2X35F	36	6,0 x 35	91	56	PZ2	45



FLUO

Rfid

PROTWIST® SCREWDRIVER FLUO

■ ANXR - PROTWIST® screwdrivers for Resistorx® screws - FLUO



■ AP.VEF - PROTWIST® 1000 Volt insulated screwdrivers for Phillips® head screws - FLUO

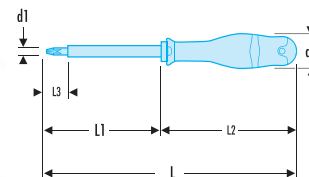
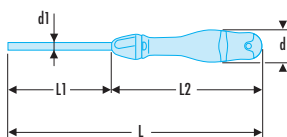

- Detect the tool thanks to its fluorescence, activated by a lamp or UV neon light. Detectable in black or dark environment up to 5 meters.
- Compliant with Resistorx® specifications.
- Silicon carbon blade: strong and resistant to flexion.
- Bi-material grip resists to impacts, abrasion, and chemicals.
- Finish: black tipped mat chromed blade.

- NF ISO 8764-1, NF ISO 8764-2, NF EN 60900, ISO 8764-1, ISO 8764-2, EN 60900, DIN ISO 8764-1, DIN ISO 8764-2, DIN EN 60900, ASME B107.600**
- Detect the tool thanks to its fluorescence, activated by a lamp or UV neon light. Detectable in black or dark environment up to 5 meters.
 - For your safety, each screwdriver is tested individually at 10000 Volts for 10 seconds, at the end of the manufacturing cycle.
 - 1000 Volt sheathed round blade.
 - Bi-material grip resists to impacts, abrasion, and chemicals.

FACOM	A [mm]	d [mm]	d1 x L1 [mm]	L [mm]	L2 [mm]	Resistorx [No]	ΔΔ [g]
ANXR10X75F	2,74	25	3,0 x 75	184	109	TT10	50
ANXR15X75F	3,26	30	3,5 x 75	185	110	TT15	61
ANXR20X100F	3,84	36	4,0 x 100	220	120	TT20	67
ANXR25X100F	4,40	36	5,0 x 100	220	120	TT25	113
ANXR27X100F	4,96	36	5,5 x 100	220	120	TT27	113
ANXR30X125F	5,49	36	6,0 x 125	245	120	TT30	126
ANXR40X150F	6,60	40	7,0 x 150	275	125	TT40	173

FACOM	d [mm]	d1 [mm]	L [mm]	L1 [mm]	L2 [mm]	L3 [mm]	Phillips [No]	ΔΔ [g]
AP1X100VEF	30	4,5	210	81,5	110	18	PH1	120
AP2X125VEF	36	6,0	245	106	120	18	PH2	170

■ **AD.VEF - PROTWIST® 1000 Volt insulated screwdrivers for Pozidriv® screws - FLUO**



■ **AV.EF - PROTWIST® BORNEO® screwdrivers for mixed heads - Pozidriv® - FLUO**

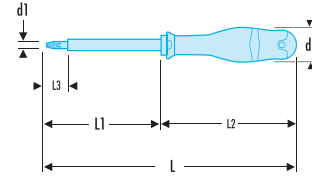
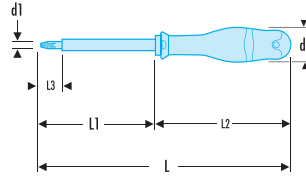

NF ISO 8764-1, NF ISO 8764-2, NF EN 60900, ISO 8764-1, ISO 8764-2, EN 60900, DIN ISO 8764-1, DIN ISO 8764-2, DIN EN 60900, ASME B107.600

- Detect the tool thanks to its fluorescence, activated by a lamp or UV neon light. Detectable in black or dark environment up to 5 meters.
- For your safety, each screwdriver is tested individually at 10000 Volts for 10 seconds, at the end of the manufacturing cycle.
- 1000 Volt sheathed round blade.
- Bi-material grip resists to impacts, abrasion, and chemicals.

	d [mm]	d1 [mm]	L [mm]	L1 [mm]	L2 [mm]	L3 [mm]	Pozidriv [No]	ΔΔ [g]
AD1X100VEF	30	4,5	209	81,5	109	18	PZ1	120
AD2X125VEF	36	6,0	245	106	120	18	PZ2	170

NF ISO 2380-1, NF ISO 2380-2, NF EN 60900, ISO 2380-1, ISO 2380-2, EN 60900, DIN ISO 2380-1, DIN ISO 2380-2, DIN EN 60900, ASME B107.600

- Detect the tool thanks to its fluorescence, activated by a lamp or UV neon light. Detectable in black or dark environment up to 5 meters.
- Screwdrivers designed specifically for mixed head screws found in electrical appliances.
- Tighter screwing = safety.
- Less slipping for better sensations and lesser wear.
- Longer screwdriver durability.
- For your safety, each screwdriver is tested individually at 10000 Volts for 10 seconds, at the end of the manufacturing cycle.
- Bi-material grip resists to impacts, abrasion, and chemicals.

	A [mm]	d [mm]	E [mm]	L [mm]	L1 [mm]	L2 [mm]	L3 [mm]	ΔΔ [g]
A2.5X75VEF	2,5	25	0,4	178	58	103	18	75
A3.5X100VEF	3,5	25	0,6	204	82	104	18	85
A4X100VEF	4,0	30	0,8	210	82	110	18	90
A5.5X125VEF	5,5	30	1,0	235	106,5	110	18	130



FLUO

Rfid



PROTWIST® SCREWDRIVER FLUO

Set of 6 PROTWIST® screwdrivers - FLUO + 1 12-LED UV lamp-ANP.J6F



- Detect the tool thanks to its fluorescence, activated by a lamp or UV neon light. Detectable in black or dark environment up to 5 meters.

Contains:

- 4 x PROTWIST® screwdriver for slotted screws - milled blades - FLUO - AN2.5X75F - AN4X100F - AN5.5X150F - AN6.5X150F .
- 2 x screwdriver for Phillips screws PROTWIST® Phillips® - round blades - FLUO - ANP1X100F - ANP2X125F .
- 1 UV lamp - PBC.UVLAMP .

	Content set	ΔΔ [g]
ANP.J6F	AN2.5X75F - AN4X100F - AN5.5X150F - AN6.5X150F - ANP1X100F - ANP2X125F	688

PROTWIST® KEYS FLUO

AWHS - Spherical head spinner hexagon keys - FLUO



- Detect the tool thanks to its fluorescence, activated by a lamp or UV neon light. Detectable in black or dark environment up to 5 meters.
- Bi-material ergonomic PROTWIST® handle for comfortable and reliable screwing.

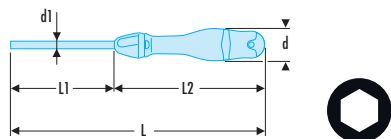

	A [mm]	d [mm]	d1 x L1 [mm]	d3 [mm]	L [mm]	L2 [mm]	ΔΔ [g]
AWSH2X75F	2,0	19	2,0 x 75	31	169	94	31
AWSH2.5X75F	2,5	19	2,5 x 75	33	169	94	33
AWSH3X75F	3,0	19	3,0 x 75	35	169	94	35
AWSH4X75F	4,0	25	4,0 x 75	45	178	103	45
AWSH5X100F	5,0	30	5,0 x 100	80	208	109	80
AWSH6X100F	6,0	36	6,0 x 100	120	220	120	120
AWSH8X100F	8,0	36	8,0 x 100	180	220	120	180

KEY SLEEVE SET FLUO

Set of hexagon keys in wallet - FLUO



- Detect the tool thanks to its fluorescence, activated by a lamp or UV neon light. Detectable in black or dark environment up to 5 meters.
- 8 keys 83SH in inches: 3/32 - 1/8 - 5/32 - 3/16 - 7/32 - 1/4 - 5/16 - 3/8".
- Very compact sleeve.
- Positive grip.
- Keys on 90° end stop for tightening.
- Keys in silicon steel issued from series 82H.
- Finish: phosphate-coated.



	ΔΔ [g]
83SH.JP8UF	365

■ Set of hexagon keys in wallet - FLUO

- Detect the tool thanks to its fluorescence, activated by a lamp or UV neon light. Detectable in black or dark environment up to 5 meters.
- 9 metric keys 83SH: 1,5 - 2 - 2,5 - 3 - 4 - 5 - 6 - 8 - 10 mm.
- Very compact sleeve.
- Positive grip.
- Keys on 90° end stop for tightening.
- Keys in silicon steel issued from series 82H.
- Finish: phosphate-coated.



Part Number	Weight $\Delta\Delta$ [g]
83SH.JP9F	380

■ 84TZS.F - Spherical head metric hexagon keys - FLUO

- Detect the tool thanks to its fluorescence, activated by a lamp or UV neon light. Detectable in black or dark environment up to 5 meters.
- Ergonomic T handle for efficient use of the two ends of the key.
- The spherical head allows for screwing with a tilt angle up to 30°. Use the short hexagon key for tightening.
- Silicon steel.
- Finish: polished, phosphate-coated.

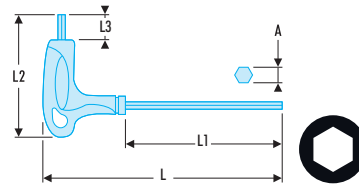

Part Number	A [mm]	L [mm]	L1 [mm]	L2 [mm]	L3 [mm]	Weight $\Delta\Delta$ [g]
84TZS.4F	4	183	130	77	12	58
84TZS.5F	5	183	130	77	12	70
84TZS.6F	6	240	175	95	15	112
84TZS.7F	7	240	175	95	15	120
84TZS.8F	8	240	175	95	15	125
84TZS.10F	10	240	175	95	15	192

BITS FLUO

■ Empty box 63 bits - FLUO

- Detect the tool thanks to its fluorescence, activated by a lamp or UV neon light. Detectable in black or dark environment up to 5 meters.



Part Number	Weight $\Delta\Delta$ [g]
BV.E1063F	170



■ Set of 63 bits - FLUO

- Detect the tool thanks to its fluorescence, activated by a lamp or UV neon light. Detectable in black or dark environment up to 5 meters.
- Contains:
- 7 x High Perf® series 1 for Phillips screws Pozidriv® - ED.102TF.
 - 7 x standard series 1 for screw caps 6 metric hollow sections - EH.104TF.
 - 7 x High Perf tips® series 1 for Phillips screws Phillips® - EP.101TF.
 - 7 x High Perf tips® series 1 for Phillips screws Phillips® - EP.102TF.
 - 7 x standard series 1 recessed screw caps for Torq Set® - ETORM.102TF.
 - 7 x standard series 1 recessed screw caps for Torq Set® - ETORM.104TF.
 - 7 x standard series 1 recessed screw caps for Torq Set® - ETORM.106TF.
 - 7 x 1 standard serial bits for Torx® screws - EX.115TF.
 - 7 x 1 standard serial bits for Torx® screws - EX.120TF.



Part Number	Weight $\Delta\Delta$ [g]
E.1063F	250



FLUO

RFid

BITS FLUO

■ ES.1TF - High Perf' bits series 1 for slotted head screws - FLUO

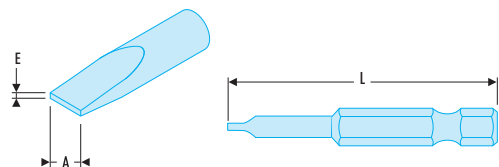

NF ISO 2351-1, NF ISO 1173, ISO 2351-1, ISO 1173, DIN ISO 2351-1

- Detect the tool thanks to its fluorescence, activated by a lamp or UV neon light. Detectable in black or dark environment up to 5 meters.
- For intense manual screwing.
- Drive 1/4" - 6.35 mm.

	A [mm]	E [mm]	L [mm]	ΔΔ [g]
ES.134.5TF	4,5	0,6	25	5
ES.135.5TF	5,5	0,8	25	5

■ ES.6TF - Standard bits series 6 for slotted head screws - FLUO



NF ISO 2351-2, NF ISO 1173, ISO 2351-2, ISO 1173, DIN ISO 2351-2

- Detect the tool thanks to its fluorescence, activated by a lamp or UV neon light. Detectable in black or dark environment up to 5 meters.
- Drive 1/4" - 6.35 mm with groove.

	L [mm]	ΔΔ [g]
ES.634.5TF	50	15

■ EP.1TF - Standard bits series 1 for Phillips® screws - FLUO

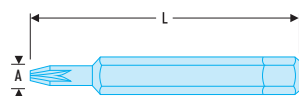

NF ISO 2351-2, NF ISO 1173, ISO 2351-2, ISO 1173, DIN ISO 2351-2

- Detect the tool thanks to its fluorescence, activated by a lamp or UV neon light. Detectable in black or dark environment up to 5 meters.
- For manual screwing.
- Drive 1/4" - 6.35 mm.

	L [mm]	Phillips [No]	ΔΔ [g]
EP.101TF	25	PH1	5
EP.102TF	25	PH2	5
EP.103TF	25	PH3	5

■ EP.6TF - Standard bits series 6 for Phillips® screws - FLUO



NF ISO 2351-2, NF ISO 1173, ISO 2351-2, ISO 1173, DIN ISO 2351-2

- Detect the tool thanks to its fluorescence, activated by a lamp or UV neon light. Detectable in black or dark environment up to 5 meters.
- Drive 1/4" - 6.35 mm with groove.

	L [mm]	Phillips [No]	ΔΔ [g]
EP.601TF	50	PH1	10
EP.602TF	50	PH2	10
EP.603TF	50	PH3	10

■ ED.1TF - High Perf' bits series 1 for Pozidriv® screws - FLUO



NF ISO 2351-2, NF ISO 1173, ISO 2351-2, ISO 1173, DIN ISO 2351-2

- Detect the tool thanks to its fluorescence, activated by a lamp or UV neon light. Detectable in black or dark environment up to 5 meters.
- For intense manual screwing.
- Drive 1/4" - 6.35 mm.

	L [mm]	Pozidriv [No]	ΔΔ [g]
ED.101TF	25	PZ1	5
ED.102TF	25	PZ2	5
ED.103TF	25	PZ3	5

■ ED.60TF - For Pozidriv® screws - FLUO



NF ISO 2351-2, NF ISO 1173, ISO 2351-2, ISO 1173, DIN ISO 2351-2

- Detect the tool thanks to its fluorescence, activated by a lamp or UV neon light. Detectable in black or dark environment up to 5 meters.
- Drive 1/4" - 6.35 mm with groove.

	L [mm]	Pozidriv [No]	ΔΔ [g]
ED.601TF	50	PZ1	10
ED.602TF	50	PZ2	10
ED.603TF	50	PZ3	10

EH.1TF - Screw bits series 1 for metric countersunk hex head screws - FLUO

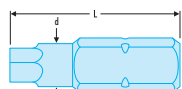

NF ISO 2351-3, NF ISO 1173, ISO 2351-3, ISO 1173, DIN ISO 2351-3

- Detect the tool thanks to its fluorescence, activated by a lamp or UV neon light. Detectable in black or dark environment up to 5 meters.
- For manual screwing.
- Drive 1/4" - 6.35 mm.

➤	L [mm]	⌀ [mm]	ΔΔ [g]
EH.101.5TF	25	1,5	5
EH.102.5TF	25	2,5	5
EH.102TF	25	2,0	5
EH.103TF	25	3,0	5
EH.104TF	25	4,0	5
EH.105TF	25	5,0	5

EH.1FT - Screw bits series 1 for inch countersunk hex head screws - FLUO

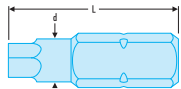

NF ISO 1173, ISO 1173

- Detect the tool thanks to its fluorescence, activated by a lamp or UV neon light. Detectable in black or dark environment up to 5 meters.
- For manual screwing.
- Drive 1/4" - 6.35 mm.

➤	A ["]	L [mm]	ΔΔ [g]
EH.101/8TF	1/8	25	5
EH.103/16TF	3/16	25	5
EH.105/32TF	5/32	25	5
EH.107/32TF	7/32	25	5
EH.107/64TF	1/8	25	10
EH.109/64TF	7/32	25	10
EH.3/32TF	3/32	25	10
EH.5/64TF	5/64	25	10

EH.6FT - Standard bits series 6 for countersunk hex screws - FLUO

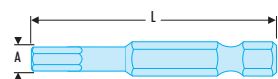

NF ISO 2351-3, NF ISO 1173, ISO 2351-3, ISO 1173, DIN ISO 2351-3

- Detect the tool thanks to its fluorescence, activated by a lamp or UV neon light. Detectable in black or dark environment up to 5 meters.
- Drive 1/4" - 6.35 mm with groove.

➤	L [mm]	⌀ [mm]	ΔΔ [g]
EH.603TF	50	3	15
EH.605TF	50	5	15

EH.6TF - Screw bits series 6 for inch countersunk hex head screws - FLUO

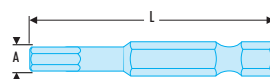

NF ISO 2351-3, NF ISO 1173, ISO 2351-3, ISO 1173, DIN ISO 2351-3

- Detect the tool thanks to its fluorescence, activated by a lamp or UV neon light. Detectable in black or dark environment up to 5 meters.
- Drive 1/4" - 6.35 mm with groove.

➤	L [mm]	ΔΔ [g]
EH.601/8TF	50	10
EH.603/16TF	50	10
EH.605/32TF	50	10
EH.607/32TF	50	10

EX.1TF - Standard bits series 1 for Torx® screws - FLUO

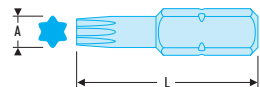

NF ISO 1173, ISO 1173

- Detect the tool thanks to its fluorescence, activated by a lamp or UV neon light. Detectable in black or dark environment up to 5 meters.
- Compliant with Torx® specifications.
- For manual screwing.
- Drive 1/4" - 6.35 mm.

➤	A [mm]	L [mm]	Torx [No]	ΔΔ [g]
EX.110TF	2,72	25	T10	5
EX.115TF	3,26	25	T15	5
EX.120TF	3,84	25	T20	5
EX.125TF	4,40	25	T25	5
EX.127TF	4,96	25	T27	5
EX.130TF	5,49	25	T30	5

EX.6TF - Standard bits series 6 for Torx® screws - FLUO

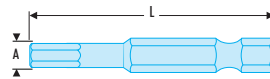

NF ISO 1173, ISO 1173

- Detect the tool thanks to its fluorescence, activated by a lamp or UV neon light. Detectable in black or dark environment up to 5 meters.
- Compliant with Torx® specifications.
- Drive 1/4" - 6.35 mm with groove.

➤	L [mm]	Torx [No]	ΔΔ [g]
EX.608TF	70	T8	10
EX.609TF	70	T9	10
EX.610TF	70	T10	10
EX.615TF	70	T15	10
EX.620TF	70	T20	10
EX.625TF	70	T25	10
EX.627TF	70	T27	10
EX.630TF	70	T30	15



BITS FLUO

■ **ETOR.TF - Standard bits series 1 for Torq Set® head screws - FLUO**



NF ISO 1173, ISO 1173

- Detect the tool thanks to its fluorescence, activated by a lamp or UV neon light. Detectable in black or dark environment up to 5 meters.
- For manual screwing.
- Drive 1/4" - 6.35 mm.

🔪	L [mm]	Screw Size [mm]	ΔΔ [g]
ETOR.100TF	25	0	5
ETOR.101TF	25	1	5

■ **ETORM.TF - Standard bits series 1 for Torq Set® head screws - FLUO**



NF ISO 1173, ISO 1173

- Detect the tool thanks to its fluorescence, activated by a lamp or UV neon light. Detectable in black or dark environment up to 5 meters.
- For manual screwing.
- Drive 1/4" - 6.35 mm.

🔪	L [mm]	Torq-set [No]	ΔΔ [g]
ETORM.102TF	25	2	5
ETORM.103TF	25	3	5
ETORM.104TF	25	4	5
ETORM.105TF	25	5	5
ETORM.106TF	25	6	5

■ **ETORM.6TF - Standard bits series 6 for Torq set® head screws - FLUO**



NF ISO 1173, ISO 1173

- Detect the tool thanks to its fluorescence, activated by a lamp or UV neon light. Detectable in black or dark environment up to 5 meters.
- Drive 1/4" - 6.35 mm with groove.

🔪	L [mm]	Torq-set [No]	ΔΔ [g]
ETORM.602TF	50	2	15
ETORM.603TF	50	3	15
ETORM.604TF	50	4	15
ETORM.605TF	50	5	15
ETORM.606TF	50	6	15

■ **ETRI.1TF - Standard bits series 1 for Tri-wing head screws - FLUO**



NF ISO 1173, ISO 1173

- Detect the tool thanks to its fluorescence, activated by a lamp or UV neon light. Detectable in black or dark environment up to 5 meters.
- For manual screwing.
- Drive 1/4" - 6.35 mm.

🔪	L [mm]	ΔΔ [g]
ETRI.101TF	25	5
ETRI.102TF	25	5
ETRI.103TF	25	5
ETRI.104TF	25	5
ETRI.105TF	25	5

BIT HOLDERS AND ACCESSORIES FLUO

■ **1/4" drive lock-ring bit holder - FLUO**



NF ISO 2725-3, NF ISO 1173, ISO 2725-3, ISO 1173, DIN 3124

- Detect the tool thanks to its fluorescence, activated by a lamp or UV neon light. Detectable in black or dark environment up to 5 meters.
- Bit lock.
- Square drive has side-hole for ball or plunger lock.

🔪	A ["]	L [mm]	Square ["]	ΔΔ [g]
EF.RF	1/4	30	1/4	26
EF.JF	1/4	43	3/8	48

■ **Magnetic snap ring bit holder - FLUO**



NF ISO 1173, ISO 1173

- 1/4" drive - 6.35 mm.

🔪	L [mm]	ΔΔ [g]
EF.6P4F	75	36

▪ Locking ring bit holder - FLUO

NF ISO 1173, ISO 1173

- 1/4" drive - 6.35 mm.
- Fast bit changing.



	L [mm]	ΔΔ [g]
EF.6P5F	51	31



▪ PROTWIST® bit holder screwdriver - FLUO

- Detect the tool thanks to its fluorescence, activated by a lamp or UV neon light. Detectable in black or dark environment up to 5 meters.
- Bi-material ergonomic handle for comfortable and reliable screwing.
- AM.M2: Long magnetic model.



	d [mm]	L [mm]	L1 [mm]	ΔΔ [g]
AM.M2F	10	245	125	150

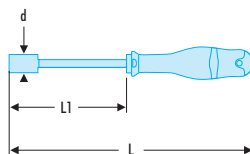

▪ Socket holder - 1/4" square drive - FLUO

NF ISO 1173, ISO 1173

- Detect the tool thanks to its fluorescence, activated by a lamp or UV neon light. Detectable in black or dark environment up to 5 meters.
- Drive 1/4" - 6.35 mm.
- Locking by plunger.



	L [mm]	ΔΔ [g]
EF.6RF	50	16



▪ Long socket holder - 1/4" square drive - FLUO

NF ISO 1173, ISO 1173

- Detect the tool thanks to its fluorescence, activated by a lamp or UV neon light. Detectable in black or dark environment up to 5 meters.
- Drive 1/4" - 6.35 mm.
- Locking by plunger.



	L [mm]	ΔΔ [g]
EF.6RLF	100	38



FLUO

Rfid



ENGINEERS MULTIGRIP PLIERS FLUO

Fluorescent standard multigrip pliers

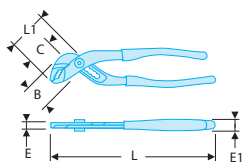

- Detect the tool thanks to its fluorescence, activated by a lamp or UV neon light. Detectable in black or dark environment up to 5 metres.
- Wide jaws for comfortable use.
- Self-gripping teeth.
- 8 setting positions.
- Rack and flexible pivot for less blocking points.
- Finger clearance.
- PVC sheaths.



	B [mm]	C [mm]	E [mm]	E1 [mm]	H [mm]	L [mm]	L1 [mm]	Capacity Nuts [mm]	Capacity Maxi Tube [mm]	ΔΔ [g]
170A.25F	34	34	8	17	58	250	54	40	44	330

Slip-joint multigrip pliers - FLUO

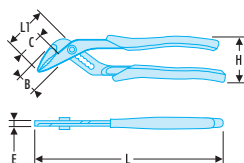

- NF ISO 8976, ISO 8976, DIN ISO 8976, ASME B107.500**
- Detect the tool thanks to its fluorescence, activated by a lamp or UV neon light. Detectable in black or dark environment up to 5 meters.
 - Capacity: 44 mm.
 - Ideal for confined spaces: Long reach thin noses.
 - Double heat-treated tips: high wear resistance, hardness 60/62 HRc.
 - Finish: chromed, bi-material ergonomic grips.



	B [mm]	C [mm]	E [mm]	E1 [mm]	L [mm]	L1 [mm]	ΔΔ [g]
180.CPEF	30	35	8	22	250	58	360

181A - Locking twin slip-joint multigrip pliers - FLUO

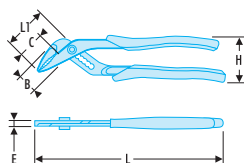

- NF ISO 8976, ISO 8976, DIN ISO 8976, ASME B107.500**
- Detect the tool thanks to its fluorescence, activated by a lamp or UV neon light. Detectable in black or dark environment up to 5 meters.
 - Fast, precise push-button adjustment with safety lock.
 - 12-position notches.
 - The closed position of the ergonomic comfort grip handles increases the tightening power.
 - High torsional strength.
 - Slim-profile self-gripping nose.
 - 62 HRC high-frequency treated jaws.
 - Finish:
 - Chromed, bi-material ergonomic grips: 181A.CPE.
 - Varnish finish, PVC grips: 181A.G.



	B [mm]	C [mm]	E [mm]	L [mm]	L1 [mm]	Cut	ΔΔ [g]
181A.18CPEF	22	24	7,5	185	48	36	230
181A.25CPEF	28	28	7,5	245	54	41	360

PLIERS FLUO

192.CPE High-performance diagonal cutters - FLUO

NF ISO 5749, ISO 5749, DIN ISO 5749, ASME B107.500

- Fluorescent tool, detectable by ultraviolet light. Detectable in dark and dimly lit areas for 5 meters.
- Cutting edges designed to cleanly cut all types of wire: piano wire, soft wires and modern materials 200 kg/mm².
- Minimum cutting force thanks to long lever arm and offset axis.
- High durability Chrome-Molybdenum-Vanadium steel, very hard cutting edges 61/63 HRC.
- Ergonomic grips resistant to chemical agents.
- Removable return spring.
- Finish: chromed.

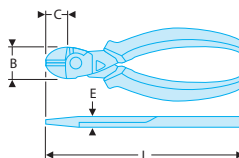

Model	B [mm]	B1 [mm]	C [mm]	E [mm]	L [mm]	ΔΔ [g]
192.14CPEF	21,5	1,4	15,5	9,5	145	160
192.16CPEF	24,0	1,5	18,0	10,0	160	200
192.20CPEF	28,0	2,2	22,0	11,5	200	320

190.CPE - High-performance end cutters - FLUO

NF ISO 5748, ISO 5748, DIN ISO 5748, ASME B107.500

- Fluorescent tool, detectable by ultraviolet light. Detectable in dark and dimly lit areas for 5 meters.
- Cutting edges designed to cleanly cut all types of wire: piano wire, hard and soft wires (max. 200 kg/mm²).
- Long lever arm, offset pivot for minimum cutting effort.
- High durability Chrome-Molybdenum-Vanadium steel, very hard cutting edges 61/63 HRC.
- Ergonomic grips resistant to chemical agents.
- Removable return spring.
- Finish: chromed.

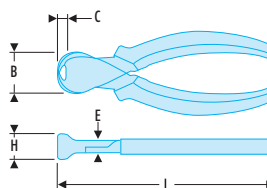

Model	B [mm]	C [mm]	E [mm]	H [mm]	L [mm]	ΔΔ [g]
190.16CPEF	28	6,5	11,5	23	160	200
190.20CPEF	31	7,5	13,5	29	200	340

Long half-round nose pliers - FLUO

NF ISO 5745, ISO 5745, DIN ISO 5745, ASME B107.500

- Fluorescent tool, detectable by ultraviolet light. Detectable in dark and dimly lit areas for 5 meters.
- Narrow, finely serrated tips with a pipe-grip.
- Side cutter for copper and hard steel wire (max. 160 kg/mm²).
- 185: straight nose.
- 195: 40° angled nose.
- Ergonomic grips resistant to chemical agents.
- Removable return spring.
- Finish: chromed.

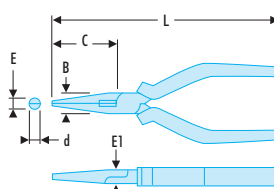

Model	B [mm]	C [mm]	d [mm]	E [mm]	E1 [mm]	L [mm]	ΔΔ [g]
185.20CPEF	18	75	75	3,6	9	200	192

195.CPEF - Short half-round nose pliers - FLUO

NF ISO 5745, ISO 5745, DIN ISO 5745, ASME B107.500

- Fluorescent tool, detectable by ultraviolet light. Detectable in dark and dimly lit areas for 5 meters.
- Narrow, finely serrated tips, 40° angled nose.
- Side cutter for copper and hard steel wire (max. 160 kg/mm²).
- Ergonomic grips resistant to chemical agents.
- Removable return spring.
- Finish: chromed.

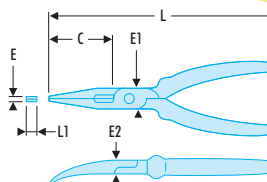

Model	B [mm]	C [mm]	d [mm]	E [mm]	E1 [mm]	L [mm]	ΔΔ [g]
195.16CPEF	17	50	50	3	9	160	177
195.20CPEF	18	69	2,9	3,6	9	200	215



FLUO

RFid

PLIERS FLUO

Half-round long snipe-nose pliers - FLUO

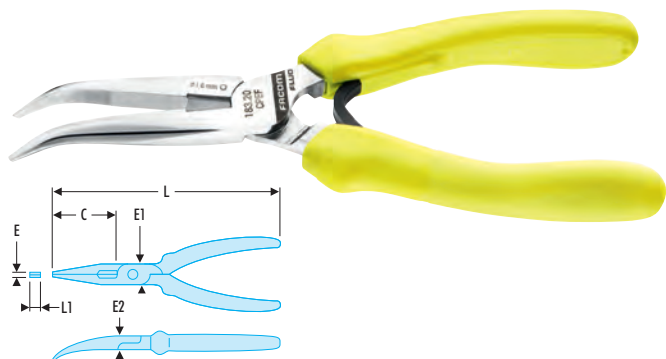

NF ISO 5745, ISO 5745, DIN ISO 5745, ASME B107.500

- Fluorescent tool, detectable by ultraviolet light. Detectable in dark and dimly lit areas for 5 meters.
- Narrow, finely serrated tips, 40° angled nose.
- Side cutter for copper and hard steel wire (max. 160 kg/mm²).
- Ergonomic grips resistant to chemical agents.
- Removable return spring.
- Finish: chromed.



	C [mm]	d [mm]	d3 [mm]	E [mm]	E1 [mm]	E2 [mm]	L [mm]	L1 [mm]	L2 [mm]	ΔΔ [g]
183.20CPEF	69	69	185	3	18	9	200	2,5	2,5	185

Short half-round nose pliers - FLUO

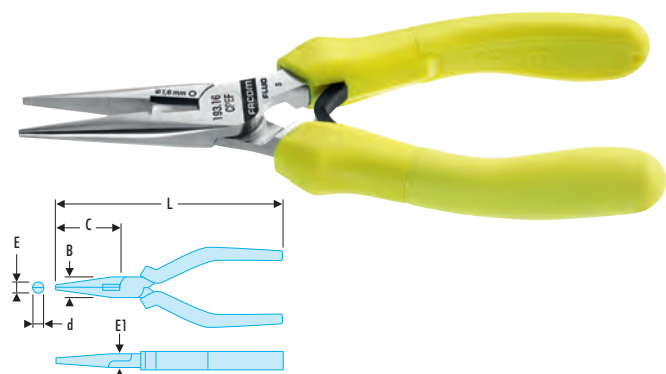

NF ISO 5745, ISO 5745, DIN ISO 5745, ASME B107.500

- Fluorescent tool, detectable by ultraviolet light. Detectable in dark and dimly lit areas for 5 meters.
- Narrow, finely serrated tips.
- Side cutter for copper and hard steel wire (max. 160 kg/mm²).
- Ergonomic grips resistant to chemical agents.
- Removable return spring.
- Finish: chromed.



	B [mm]	d [mm]	E [mm]	E1 [mm]	L [mm]	ΔΔ [g]
193.16CPEF	17	50	3	9	160	0

187.CPE - Combination pliers - FLUO

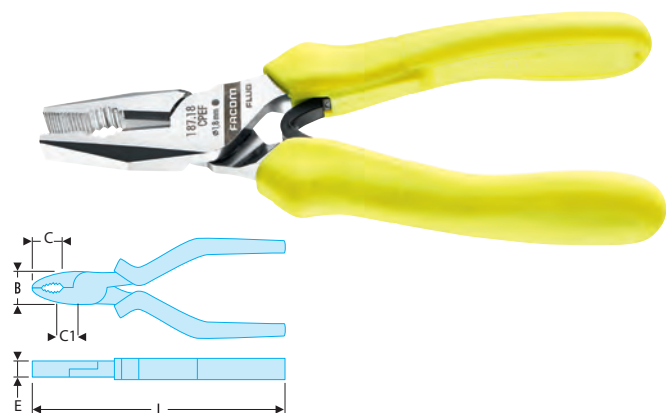

NF ISO 5746, ISO 5746, DIN ISO 5746, ASME B107.500

- Fluorescent tool, detectable by ultraviolet light. Detectable in dark and dimly lit areas for 5 meters.
- Cutting edges designed to cut all types of wire: piano wire, soft wires and modern materials (Fe 200 kg/mm²).
- Long lever arm, offset pivot for minimum cutting effort.
- High durability Chrome-Molybdenum-Vanadium steel, very hard cutting edges 61/63 HRc.
- Ergonomic grips resistant to chemical agents.
- Removable return spring.
- Finish: chromed.



	B [mm]	C [mm]	E [mm]	L [mm]	ΔΔ [g]
187.16CPEF	21	34	9,5	165	195
187.18CPEF	23	36	10,0	185	225

188 - Flat nose pliers - FLUO

NF ISO 5745, ISO 5745, DIN ISO 5745, ASME B107.500

- Fluorescent tool, detectable by ultraviolet light. Detectable in dark and dimly lit areas for 5 meters.
- Serrated nose for a firm grip.
- 188.E: snipe nose version for confined spaces.
- Ergonomic grips resistant to chemical agents.
- Removable return spring.
- Finish: chromed.

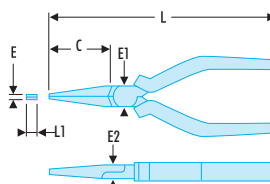

	C [mm]	E [mm]	E1 [mm]	E2 [mm]	L [mm]	L1 [mm]	ΔΔ [g]
188.16CPEF	46	4,0	18	9	168	6,5	140
188.20CPEF	75	4,0	18	9	200	6,5	200

Round nose pliers - FLUO

NF ISO 5745, ISO 5745, DIN ISO 5745, ASME B107.500

- Fluorescent tool, detectable by ultraviolet light. Detectable in dark and dimly lit areas for 5 meters.
- For shaping loops, bends or rings.
- Finely serrated jaws for positive grip.
- Diameter of each nose at the end: 2 mm.
- Ergonomic grips resistant to chemical agents.
- Removable return spring.
- Finish: chromed.

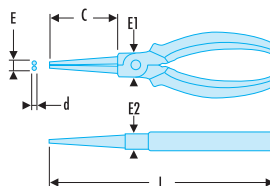

	C [mm]	d [mm]	E [mm]	E1 [mm]	E2 [mm]	L [mm]	ΔΔ [g]
189.17CPEF	41	2	4	18	9	170	135

4-piece set of pliers - FLUO

- Detect the tool thanks to its fluorescence, activated by a lamp or UV neon light. Detectable in black or dark environment up to 5 metres.

Includes:

- 1 x slip-joint locking multigrip pliers - 181A.25CPEF.
- 1 long half-round nose pliers - 185.20CPEF.
- 1 universal pliers - 187.18CPEF.
- 1 diagonal cutter - High performance - 192.16CPEF.



	Content set	ΔΔ [kg]
CPE.1F	181A.25CPEF - 185.20CPEF - 187.18CPEF - 192.16CPEF	1.1



FLUO

Rfid

PLIERS WITH OFFCUT RETAINER

192.CPEF-R - Diagonal cutters with offcut retainer - FLUO

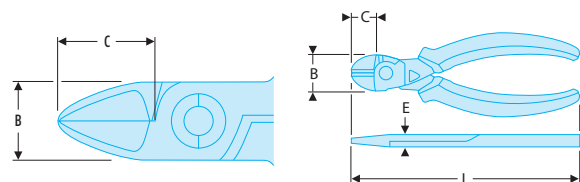

NF ISO 5749, ISO 5749, DIN ISO 5749, ASME B107.500

- Offcut retainer built into the cutting edges: the wire does not fall after cutting, hence preserving the FOD work space.
- Detect the tool thanks to its fluorescence, activated by a lamp or UV neon light. Detectable in black or dark environment up to 3 metres.
- Cutting edges designed to neatly cut all types of wires: piano wire, soft wires, modern materials (max. 200 kg/mm²).
- Minimum cutting force thanks to long lever arm and offset axis.
- High durability Chrome-Molybdenum-Vanadium steel, very hard cutting edges 61/63 HRc.
- Ergonomic grips resistant to chemical agents.
- Removable return spring.
- Chrome finish.



➤	B [mm]	C [mm]	E [mm]	L [mm]	ΔΔ [g]
192.14CPEF-R	21,5	15,5	9,5	145	160
192.16CPEF-R	24,0	18,0	10,0	160	200
192.20CPEF-R	28,0	22,0	11,5	200	320

187.CPEF-R - Universal pliers with offcut retainer - FLUO

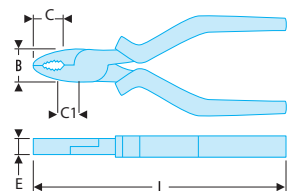

NF ISO 5746, ISO 5746, DIN ISO 5746, ASME B107.500

- Offcut retainer built into the cutting edges: the wire does not fall after cutting, hence preserving the FOD work space.
- Detect the tool thanks to its fluorescence, activated by a lamp or UV neon light. Detectable in black or dark environment up to 3 metres.
- Cutting edges designed to cut all types of wires: piano wire, soft wires, modern materials (max. Fe 200 kg/mm²).
- Long lever arm, offset pivot for minimum cutting effort.
- High durability Chrome-Molybdenum-Vanadium steel, very hard cutting edges 61/63 HRc.
- Ergonomic grips resistant to chemical agents.
- Removable return spring.
- Chrome finish.



➤	B [mm]	C [mm]	E [mm]	L [mm]	ΔΔ [g]
187.16CPEF-R	21	34	9,5	165	195
187.18CPEF-R	23	36	10,0	185	196

Long-reach half-round nose pliers with offcut retainer - FLUO

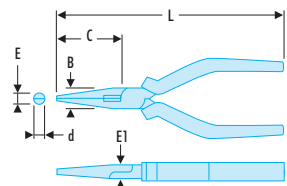

NF ISO 5745, ISO 5745, DIN ISO 5745, ASME B107.500

- Offcut retainer built into the cutting edges: the wire does not fall after cutting, hence preserving the FOD work space.
- Detect the tool thanks to its fluorescence, activated by a lamp or UV neon light. Detectable in black or dark environment up to 3 metres.
- Narrow, finely serrated tips with a pipe-grip.
- Side cutter for copper and hard steel wire (max. 160 kg/mm²).
- 185: Straight nose.
- Ergonomic grips resistant to chemical agents.
- Removable return spring.
- Chrome finish.



➤	B [mm]	C [mm]	d [mm]	E [mm]	E1 [mm]	L [mm]	ΔΔ [g]
185.20CPEF-R	18	75	75	3,6	9	200	192

■ Long-reach half-round nose pliers with offcut retainer

NF ISO 5745, ISO 5745, DIN ISO 5745, ASME B107.500

- Offcut retainer built into the cutting edges: the wire does not fall after cutting, hence preserving the FOD work space.
- Detect the tool thanks to its fluorescence, activated by a lamp or UV neon light. Detectable in black or dark environment up to 3 metres.
- Narrow, finely serrated tips, 40° angled nose.
- Side cutter for copper and hard steel wire (max. 160 kg/mm²).
- Ergonomic grips resistant to chemical agents.
- Removable return spring.
- Chrome finish.

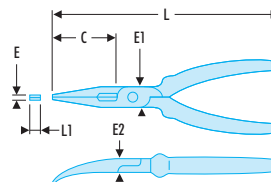

Icon	C [mm]	d [mm]	E [mm]	E1 [mm]	E2 [mm]	L [mm]	L1 [mm]	ΔΔ [g]
183.20CPEF-R	69	69	3	18	9	200	2,5	185

■ Short half-round nose pliers with offcut retainer - FLUO

NF ISO 5745, ISO 5745, DIN ISO 5745, ASME B107.500

- Offcut retainer built into the cutting edges: the wire does not fall after cutting, hence preserving the FOD work space.
- Detect the tool thanks to its fluorescence, activated by a lamp or UV neon light. Detectable in black or dark environment up to 3 metres.
- Narrow, finely serrated tips, 40° angled nose.
- Side cutter for copper and hard steel wire (max. 160 kg/mm²).
- Ergonomic grips resistant to chemical agents.
- Removable return spring.
- Chrome finish.

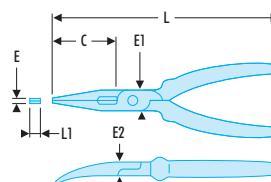

Icon	B [mm]	C [mm]	d [mm]	E [mm]	E1 [mm]	L [mm]	ΔΔ [g]
195.16CPEF-R	17	50	50	3	9	160	177

■ 3-piece pliers with offcut retainer set in foam tray - FLUO

- Contains :
 - 185.20CPEF-R: half-round nose pliers.
 - 187.18CPEF-R: universal pliers.
 - 192.16CPEF-R: diagonal cutting pliers.
 - Foam tray: PM.MODCPE.



Icon	H [mm]	Width l [mm]	L [mm]	ΔΔ [g]
MODM.CPE-R	45	188	410	750



FLUO

RFid

PLIERS WITH OFFCUT RETAINER

Micro-Tech® "thin-nose tip" cutters with offcut retainer - FLUO

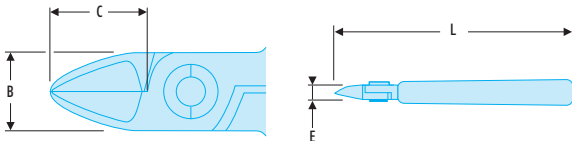

NF ISO 9654, ISO 9654, DIN ISO 9654, ASME B107.500

- Offcut retainer built into the cutting edges: the wire does not fall after cutting, hence preserving the FOD work space.
- Detect the tool thanks to its fluorescence, activated by a lamp or UV neon light. Detectable in black or dark environment up to 3 metres.
- Compact nose tips for confined spaces.



ED	B [mm]	C [mm]	E [mm]	L [mm]	Cu - Ni Ø [mm]	Fe 30 HRc diam. [mm]	ΔΔ [g]
416.RMTF	10,5	10,5	7	110	0,1 - 0,9	0,5	60

Micro-Tech® "compact" cutters with offcut retainer - FLUO

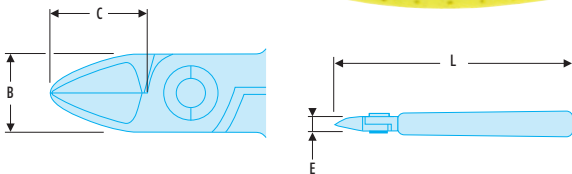

NF ISO 9654, ISO 9654, DIN ISO 9654, ASME B107.500

- Offcut retainer built into the cutting edges: the wire does not fall after cutting, hence preserving the FOD work space.
- Detect the tool thanks to its fluorescence, activated by a lamp or UV neon light. Detectable in black or dark environment up to 3 metres.
- These pliers combine cutting performance with handling thanks to their new slim diagonal shape.



ED	B [mm]	C [mm]	E [mm]	L [mm]	Cu - Ni Ø [mm]	Fe 30 HRc diam. [mm]	ΔΔ [g]
406.RMTF	10,5	9,5	7	110	0,1 - 1,1	0,6	60

Micro-Tech® "rugged" cutters with offcut retainer - FLUO

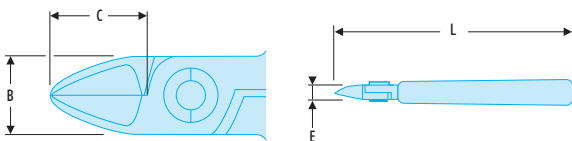

NF ISO 9654, ISO 9654, DIN ISO 9654, ASME B107.500

- Offcut retainer built into the cutting edges: the wire does not fall after cutting, hence preserving the FOD work space.
- Detect the tool thanks to its fluorescence, activated by a lamp or UV neon light. Detectable in black or dark environment up to 3 metres.
- These pliers allow neat cutting of multiple materials: from copper wire to piano wire up to 0.5 mm.



ED	B [mm]	C [mm]	E [mm]	L [mm]	Cu - Ni Ø [mm]	Fe 30 HRc diam. [mm]	ΔΔ [g]
405.10RMTF	10,5	11,5	7	110	0,3 - 1,4	0,7	60

ELECTRICAL ENGINEERS PLIERS FLUO

Micro-Tech® 60° angled rigid nose grippers - FLUO

NF ISO 9655, ISO 9655, DIN ISO 9655, ASME B107.500

- Detect the tool thanks to its fluorescence, activated by a lamp or UV neon light. Detectable in black or dark environment up to 5 meters.

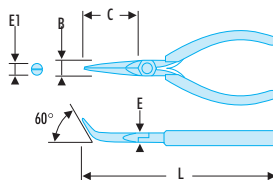

423.MTF	B [mm]	C [mm]	E [mm]	E1 [mm]	L [mm]	ΔΔ [g]
423.MTF	11	25	7	1,4	125	70

Micro-Tech® 45° angled thin nose grippers - FLUO

NF ISO 9655, ISO 9655, DIN ISO 9655, ASME B107.500

- Detect the tool thanks to its fluorescence, activated by a lamp or UV neon light. Detectable in black or dark environment up to 5 meters.
- Fine mesh, for high precision works.

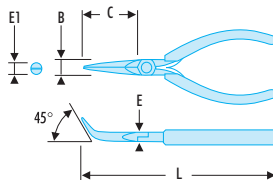

433.LMTF	B [mm]	d [mm]	E [mm]	E1 [mm]	L [mm]	ΔΔ [g]
433.LMTF	9	35	6	1,6	135	75

Micro-Tech® long and rigid nose grippers - FLUO

NF ISO 9655, ISO 9655, DIN ISO 9655, ASME B107.500

- Detect the tool thanks to its fluorescence, activated by a lamp or UV neon light. Detectable in black or dark environment up to 5 meters.

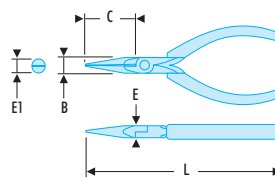

422.MTF	B [mm]	d [mm]	E [mm]	E1 [mm]	L [mm]	ΔΔ [g]
422.MTF	11	33	7	0,5	130	70



FLUO

Rfid

ELECTRICAL ENGINEERS PLIERS FLUO

Micro-Tech® flat spouts nose grippers - FLUO

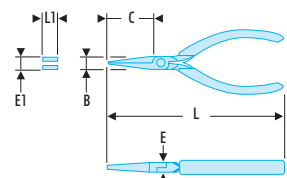

NF ISO 9655, ISO 9655, DIN ISO 9655, ASME B107.500

- Detect the tool thanks to its fluorescence, activated by a lamp or UV neon light. Detectable in black or dark environment up to 5 meters.



➤	B [mm]	d [mm]	E [mm]	E1 [mm]	L [mm]	L1 [mm]	ΔΔ [g]
421.MTF	11	33	7	1	130	5	70

Micro-Tech® thin nose grippers - FLUO

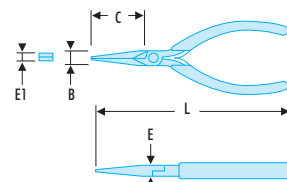

NF ISO 9655, ISO 9655, DIN ISO 9655, ASME B107.500

- Detect the tool thanks to its fluorescence, activated by a lamp or UV neon light. Detectable in black or dark environment up to 5 meters.
- Narrow mesh, for high precision works.



➤	B [mm]	d [mm]	E [mm]	E1 [mm]	L [mm]	ΔΔ [g]
431.LMTF	9	20	6	1	135	80

Micro-Tech® "machined" cutters - FLUO

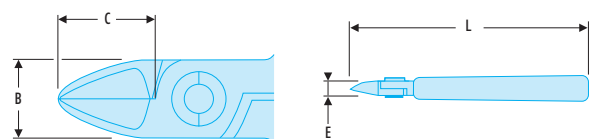

NF ISO 9654, ISO 9654, DIN ISO 9654, ASME B107.500

- Detect the tool thanks to its fluorescence, activated by a lamp or UV neon light. Detectable in black or dark environment up to 5 meters.
- Compact noses for difficult access.
- Fall prevention models avoid wire ejection.



➤	B [mm]	C [mm]	E [mm]	L [mm]	Cu - Ni Ø [mm]	Fe 30 HRC diam. [mm]	ΔΔ [g]
416.RMTF	10,5	10,5	7	110	0,1 - 0,9	0,5	60

Micro-Tech® Diagonal cutters - FLUO

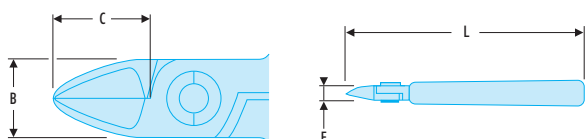

NF ISO 5749, ISO 5749, DIN ISO 5749, ASME B107.500

- Detect the tool thanks to its fluorescence, activated by a lamp or UV neon light. Detectable in black or dark environment up to 5 meters.
- 405: Axial cut.
- Finish: Matt burnished finish, red grips - return spring.

Model	B [mm]	C [mm]	E [mm]	L [mm]	L1 [mm]	ΔΔ [g]
405.12F	16,0	16,0	16,0	120	8	95

Micro-Tech® Diagonal cutters - FLUO

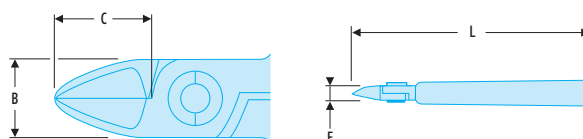

NF ISO 9654, ISO 9654, DIN ISO 9654, ASME B107.500

- Detect the tool thanks to its fluorescence, activated by a lamp or UV neon light. Detectable in black or dark environment up to 5 meters.
- 425: Flush cut, nose extended 13 mm.
- Finish: Matt burnished finish, red grips - return spring.

Model	B [mm]	C [mm]	E [mm]	L [mm]	Cu - Ni Ø [mm]	ΔΔ [g]
425F	13,0	10,5	10,5	110	0,1 - 1,3	60



FLUO

Rfid



PLIERS FLUO

Standard crimping pliers for insulated terminals - FLUO

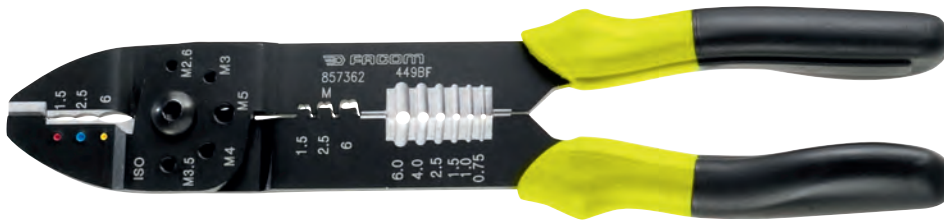

ASME B107.500

- Fluorescent tool, detectable by ultraviolet light. Detectable in dark and dimly lit areas for 5 meters.
- Crimping pre-insulated terminals: 1.5-2.5-6 mm².
- Crimping bare terminals: 1.5-2.5-6 mm².
- Stripping: 0.75 to 6 mm².
- Built-in wire cutting function.

🔗	H [mm]	L [mm]	ΔΔ [g] maxi
449BF	55	240	345

CIRCLIP® PLIERS FLUO

Straight nose inside circlip® pliers - FLUO



NF E 73-130, DIN 5254, ASME B107.500

- Fluorescent tool, detectable by ultraviolet light. Detectable in dark and dimly lit areas for 5 meters.
- For Circlips® 19 -> 60 mm.
- Piano wire tips: high distortion resistance.
- Long 10° angled tips for optimum circlip holding.
- Identification colour code: saves time.
- Grips in anti-slip granite PVC.

🔗	d [mm]	d mini - maxi [mm]	L [mm]	ΔΔ [g]
179A.18F	1,8	19 - 60	185	215
199A.18F	1,8	19 - 60	170	215

177A - Straight nose outside circlip® pliers - FLUO



NF E 73-130, DIN 5256, ASME B107.500

- Fluorescent tool, detectable by ultraviolet light. Detectable in dark and dimly lit areas for 5 meters.
- For Circlips® 19 -> 60 mm.
- Piano wire tips: high distortion resistance.
- Long 10° angled tips for optimum circlip holding.
- Identification colour code: saves time.
- Grips in anti-slip granite PVC.

🔗	d [mm]	d mini - maxi [mm]	L [mm]	ΔΔ [g]
177A.18F	1,8	19 - 60	180	175
197A.18F	1,8	19 - 60	170	175

■ **Outside circlip® pliers - FLUO**

NF E 73-130, DIN 5256, ASME B107.500

- Fluorescent tool, detectable by ultraviolet light. Detectable in dark and dimly lit areas for 5 meters.
- Interchangeable tips for a capacity of diam. 3 --> 63 mm.
- Thumbscrew position setting.
- Opening return spring.
- Finish: chrome finish, red PVC grips.
- Supplied in a case with key and set of bits E1 - E2 - E3 - E5 - E6 - E8 - E9.

	$\Delta\Delta$ [g]
467FLUO	160

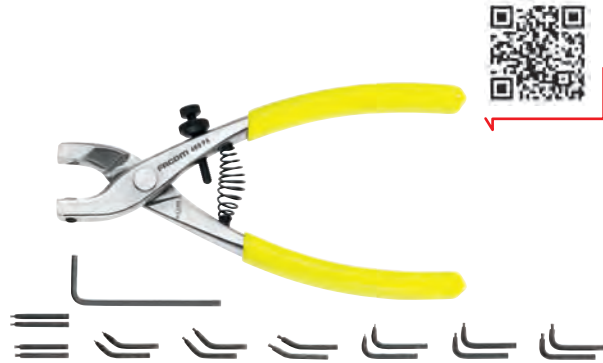

■ **Inside circlip® pliers - FLUO**

NF E 73-130, DIN 5256, ASME B107.500

- Fluorescent tool, detectable by ultraviolet light. Detectable in dark and dimly lit areas for 5 meters.
- Interchangeable tips for a capacity of diam. 8 --> 63 mm.
- Thumbscrew position setting.
- Opening return spring.
- Finish: chrome finish, red PVC grips.
- Supplied in a case with key and set of bits E1 - E2 - E3 - E5 - E6 - E8 - E9.

	$\Delta\Delta$ [g]
469F	160

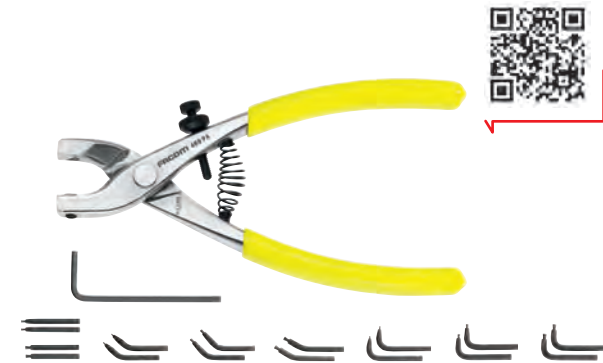

LOCKING-WIRE PLIERS FLUO

■ **445.DSF - Short locking-wire pliers - FLUO**

ASME B107.500

- Fluorescent tool, detectable by ultraviolet light. Detectable in dark and dimly lit areas for 5 meters.
- 445.8DSF = 8" / 445.10DSF = 10".
- "automatic" model.
- Side wire-cutter: stainless steel diameter 1 mm.
- 3 turns: 125 mm length.

	A	B	C	E	E1	E2	E3	H	H1	L	L1	$\Delta\Delta$
	[mm]	[mm]	[mm]	[mm]	[mm]	[mm]	[mm]	[mm]	[mm]	[mm]	[mm]	[g]
445.8DSF	3	22	9	2,2	15	29,8	14	30	41	284	170	320
445.10DSF	3	30	11	2,2	15,5	29,8	19	30	45	360	230	450

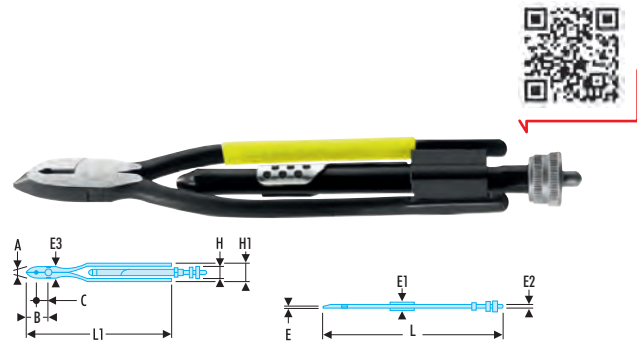

"CONNECTOR" PLIERS FLUO

■ **"Connector" pliers - FLUO**

ASME B107.500

- Fluorescent tool, detectable by ultraviolet light. Detectable in dark and dimly lit areas for 5 meters.
- For handling fragile round components, e.g. screwed connector sleeves, tubes, lamps or wire looms, etc.
- Wide capacity from 3-position slip joint: max. diameter 55 mm.
- Replaceable plastic jaws available in 2 jaw hardness options:
 - 410.SF: soft jaws - 55 shore B.
- Finish: polished chrome, red PVC grips.
- Spare jaws:
 - 410.SF: Set of 2 jaws with screws (soft).

	B [mm]	C [mm]	E [mm]	L [mm]	$\Delta\Delta$ [g]
410.SF	68	47	10	230	320

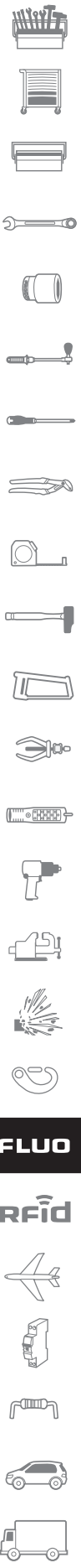

FLUO

RFid



RULES - GAUGES FLUO

Round tip metric thickness gauges - FLUO



- Fluorescent tool, detectable by ultraviolet light. Detectable in dark and dimly lit areas for 5 meters.
- Set of 19 feeler gauges (round tip): 4/100 --> 100/100 mm.
- Blade length: 90 mm.



	$\Delta\Delta$ [g]
804F	60

Long metric thickness gauges - FLUO

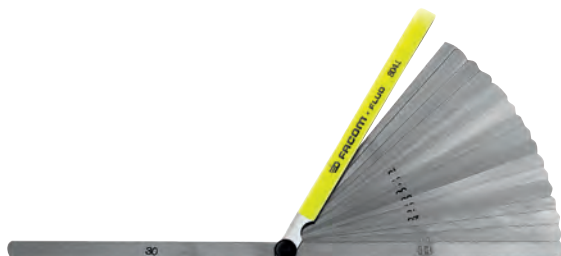

- Fluorescent tool, detectable by ultraviolet light. Detectable in dark and dimly lit areas for 5 meters.
- Set of 19 feeler gauges (round tip): 4/100 --> 25/100 mm.
- Blade length: 150 mm.



	$\Delta\Delta$ [g]
804.LF	95

DELA.1051 - Stainless steel rules - 2 sides - FLUO

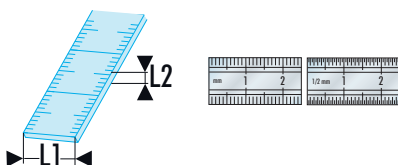

- Fluorescent tool, detectable by ultraviolet light. Detectable in dark and dimly lit areas for 5 meters.
- Engraved on both sides.
- One edge in mm - One edge in 1/2 mm.
- Stainless steel 18 % Cr - 8 % Ni.
- Anti-reflection treatment.
- Class II as per regulations applies to rules with a length above or equal to 500 mm.



	L [mm]	$\Delta\Delta$ [g]
DELA.1051.02F	150	10,9
DELA.1051.03F	200	13

MAKING-OUT FLUO

Steel scriber - FLUO



NF E 71-016, NF ISO 15601, ISO 15601

- Fluorescent tool, detectable by ultraviolet light. Detectable in dark and dimly lit areas for 5 meters.
- Tip treated in chrome vanadium steel.
- Tip: \varnothing 4 mm.

	L [mm]	$\Delta\Delta$ [g]
234F	190	20

HAMMERS - MALLETS FLUO

200C - Graphite handle riveting engineers hammer - FLUO

NF E 71-016, NF ISO 15601, ISO 15601

- Fluorescent tool, detectable by ultraviolet light. Detectable in dark and dimly lit areas for 5 meters.
- Ergonomic safety handle with graphite core.



FACOM	L [mm]	L1 [mm]	L2 [mm]	ΔΔ [kg]
200C.26F	245	80	25	0,345
200C.30F	270	93	30	0,470
200C.40F	330	108	40	1,0

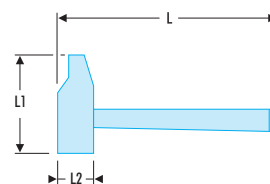

212A - Dead-blow hammers, interchangeable tips - FLUO

NF E 71-211, DIN 6450, ASME B107.410

- Fluorescent tool, detectable by ultraviolet light. Detectable in dark and dimly lit areas for 5 meters.
- Glass fiber handle.
- Steel body.
- Easily replaceable, special nylon tips shore hardness D74 ± 5.
- Ergonomic PVC grip.
- Presentation: black epoxy.
- Spare tip: 212.E35 to E60.



FACOM	d [mm]	L [mm]	L1 [mm]	Bits	ΔΔ [g]
212A.35F	35	305	112	212.E35	698
212A.40F	40	310	117	212.E40	839

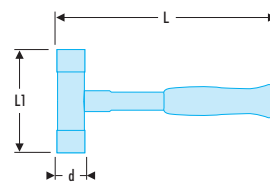

FLUO

Rfid

DRIFTS FLUO

249 - Standard drift punches - FLUO

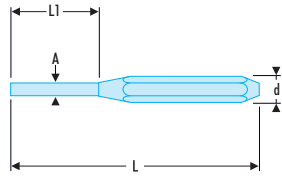

NF E 71-211, DIN 7250, ASME B107.410

- Fluorescent tool, detectable by ultraviolet light. Detectable in dark and dimly lit areas for 5 meters.
- Hexagonal shank, high-strength steel tip, hardened to 53-58 HRC.
- Zinc-plated finish.



ED	A [mm]	d [mm]	L [mm]	L1 [mm]	ΔΔ [g]
249.2F	1,9	8	115	30	30
249.3F	2,9	8	125	40	35
249.4F	3,9	10	150	50	65
249.5F	4,9	10	165	50	75
249.6F	5,9	12	180	50	120
249.8F	7,9	12	200	50	160
249.10F	9,9	16	200	50	220

DRIFT PUNCHES FLUO

256 - Precision centre punches - FLUO

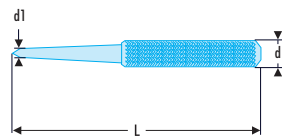

NF E 71-211, DIN 7250, ASME B107.410

- Fluorescent tool, detectable by ultraviolet light. Detectable in dark and dimly lit areas for 5 meters.
- Chrome-vanadium steel forged, hardened to 52 to 58 HRC.
- Presentation: knurled body.
- Zinc-plated finish.



ED	A [mm]	d [mm]	L [mm]	ΔΔ [g]
256.4F	4	8	105	35
256.6F	6	10	115	60
256.8F	8	12	130	100

FLUORESCENT TOOLING

SCISSORS - INSPECTION MIRRORS

Electricians scissors - FLUO



- Fluorescent tool, detectable by ultraviolet light. Detectable in dark and dimly lit areas for 5 meters.
- 100% metal handles, left/right hand.
- Short reinforced blades, with wire cutter.
- Finish: polished chromed.



ED	L [mm]	ΔΔ [g]
841F	150	95

SCISSORS - INSPECTION MIRRORS

■ Inspection mirror - FLUO

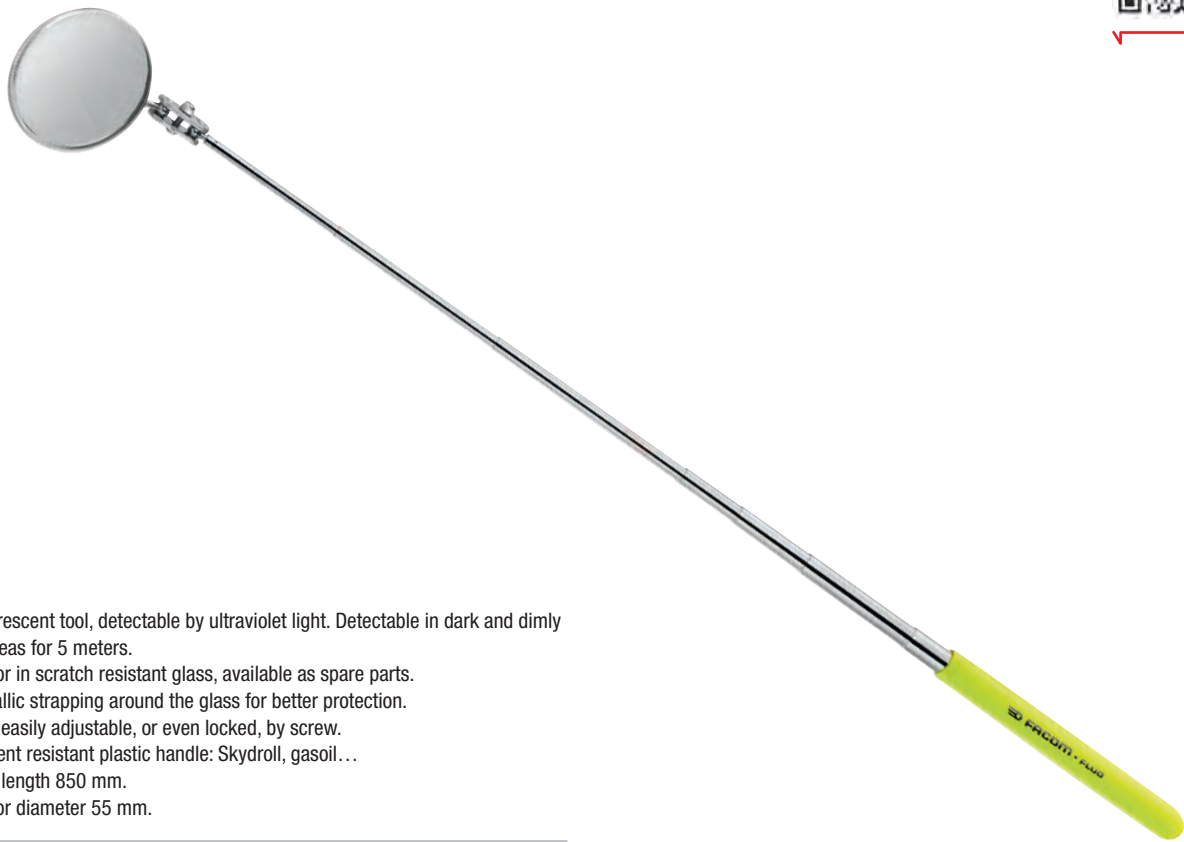

- Fluorescent tool, detectable by ultraviolet light. Detectable in dark and dimly lit areas for 5 meters.
- Mirror in scratch resistant glass, available as spare parts.
- Metallic strapping around the glass for better protection.
- Join easily adjustable, or even locked, by screw.
- Solvent resistant plastic handle: Skydroll, gasoil...
- Max length 850 mm.
- Mirror diameter 55 mm.

	$\Delta\Delta$ [g]
834B.RTF	80

■ UV torch



- 1 1W UV LED.
- 395 to 410 nm.
- Operating time: 23 hours.
- Protection rating: IP67.
- Supplied with: 3 AAA batteries, strap and protection pouch.



	$\Delta\Delta$ [g]
779.UVT	118

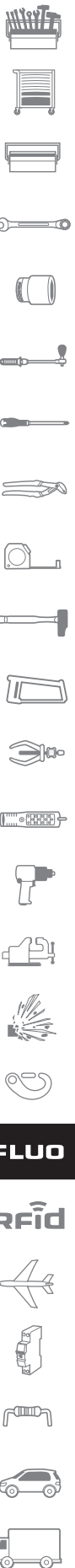

FLUO

RFid

